

Polyester Modular Enclosures - NEMA 4X

PW Series - Accessories

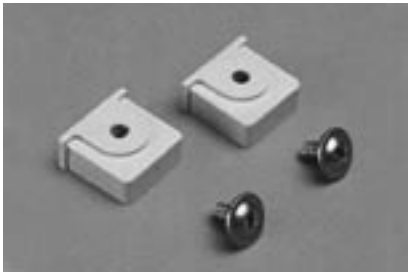

PW Series Rail Fixing Insert

- Insert nut specially designed to fit in the back of the enclosure for quick fixing of 35 mm (1.3") rails through self-tapping screws (included).
- Made of insulating material.
- Fits all sizes of PW enclosures.
- Packaged in quantities of two.

Part No. **PWIN**



Metal Double Bar Enclosure Key

- PW Enclosures use a standard double bar key. One molded key is shipped with the enclosure, however in the instance you lose the key, or would like backup, they are available for order.
- Metal key fits all sizes of PW Enclosures.
- Packaged individually.

Part No. **PMKEY**



Molded Double Bar Enclosure Key

- PW Enclosures use a standard double bar key. One is shipped with the enclosure, however in the instance you lose the key, or would like backup, they are available for order.
- Molded key fits all sizes of PW Enclosures.
- Packaged individually.

Part No. **PWKEY**



Breather Kit (Pressure Compensation Plug)

- Packaged individually.
- Provides for controlled pressure compensation due to temperature variations (i.e. night/day operation).
- Recommend two plugs per cabinet in opposite locations.
- Pipe Thread 1/2"NPT (actual dia. 0.84")

Part No. **BDN4XN1**

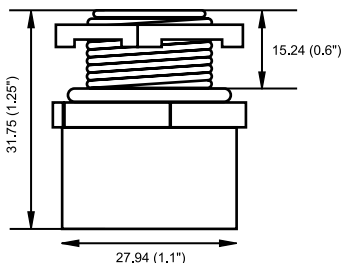

CSA/A Ex Approvals:	Class I, Zone 1, Ex e II Class I Division 2 Groups ABCD Class II EFG, Class III
Ingress Protection:	IP66, CSA Enclosure Type NEMA 4X
Impact Resistance:	20Nm (7Nm GF Nylon)
Materials:	Durethan BKV 30 N1 30% Glass Filled Nylon O Ring - Nitrile Fixing nut - Brass
Operating Temp:	-50C to +85C

Corrosion Resistant Wallmount Enclosures

Technical references and DXF downloads available at www.hamfmfg.com

All dimensions in inches unless specified otherwise

Quality Enclosures. Service Excellence.