

N1WS Series Surface Mount Panel Enclosure

3 Piece Assembly - NEMA 1



Commercial Enclosures

Application

- Designed for indoor use to enclose controls, instruments, and components which do not require oil-tight or dust-tight protection.
- Ideal for applications where components may be easily mounted and wired prior to installation of wrapper and door.

Standards

- UL 50 Type 1
- CSA Type 1
- **Complies with**
 - NEMA Type 1
 - IEC 60529, IP20

Construction

- Three piece assembly consisting of a base, wrapper, and door.
- Components are attached and secured with metal screws.
- 14 gauge reverse formed base provides clearance for mounting hardware.
- Wrapper is available in three depths: 4", 6", and 8".
- Wrapper is formed from 16 gauge steel, with no knock-outs in the sides.
- Door assembly formed from 16 gauge steel.
- Removable door is mounted on slip hinges.
- A bonding stud is provided on the door and a grounding screw is provided for the enclosure.
- Door is fastened with a slotted quarter turn latch.

Finish

- Base, wrapper and door are finished in ANSI 61 gray powder coating.

Accessories

- Surface lock kit (Part No. 1427Z)
...see page **428**
- Padlock Adaptor (Part No. EJPA)
...see page **432**

Panel Enclosures

N1WS Series Surface Mount Panel Enclosure

3 Piece Assembly - NEMA 1

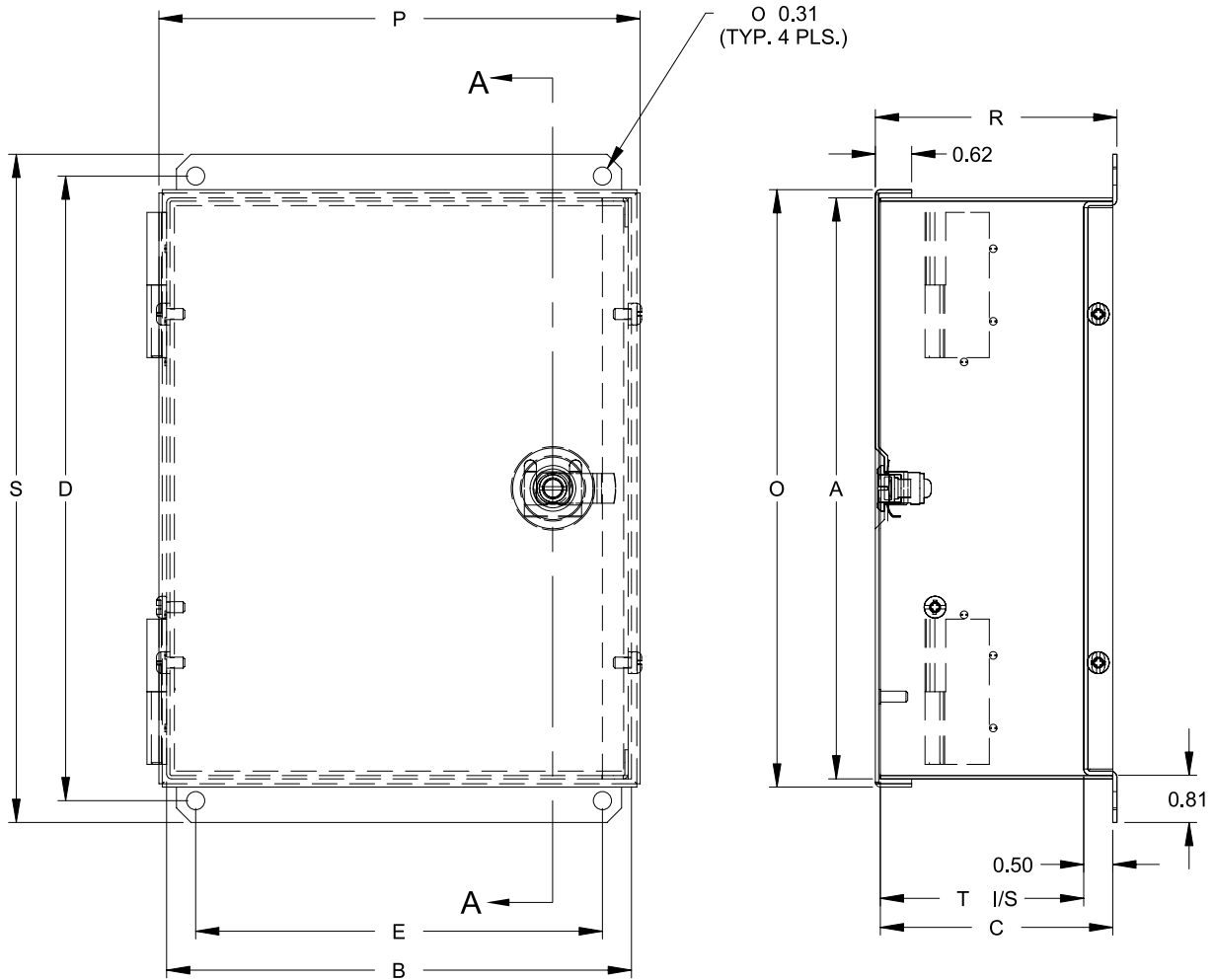

Front View

Side View

Part No.	Wrapper Size	Mounting Centers					Overall Dimensions					Ship Wt. Lbs
		A	B	C	D	E	P	R	S	T	O	
N1WS864	4" Deep	8	6	4	8.75	5	6.28	4.16	9.5	3.5	8.28	5
N1WS1084		10	8	4	10.75	7	8.28	4.16	11.5	3.5	10.28	7
N1WS12104		12	10	4	12.75	9	10.28	4.16	13.5	3.5	12.28	10
N1WS16124		16	12	4	16.75	11	12.28	4.16	17.5	3.5	16.28	14
N1WS20164		20	16	4	20.75	15	16.28	4.16	21.5	3.5	20.28	20
N1WS24204		24	20	4	24.75	19	20.28	4.16	25.5	3.5	24.28	28
N1WS866	6" Deep	8	6	6	8.75	5	6.28	6.16	9.5	5.5	8.28	6
N1WS1086		10	8	6	10.75	7	8.28	6.16	11.5	5.5	10.28	9
N1WS12106		12	10	6	12.75	9	10.28	6.16	13.5	5.5	12.28	11
N1WS16126		16	12	6	16.75	11	12.28	6.16	17.5	5.5	16.28	16
N1WS20166		20	16	6	20.75	15	16.28	6.16	21.5	5.5	20.28	22
N1WS24206		24	20	6	24.75	19	20.28	6.16	25.5	5.5	24.28	31
N1WS868	8" Deep	8	6	8	8.75	5	6.28	8.16	9.5	7.5	8.28	7
N1WS1088		10	8	8	10.75	7	8.28	8.16	11.5	7.5	10.28	10
N1WS12108		12	10	8	12.75	9	10.28	8.16	13.5	7.5	12.28	13
N1WS16128		16	12	8	16.75	11	12.28	8.16	17.5	7.5	16.28	18
N1WS20168		20	16	8	20.75	15	16.28	8.16	21.5	7.5	20.28	26
N1WS24208		24	20	8	24.75	19	20.28	8.16	25.5	7.5	24.28	34

Technical references and DXF downloads available at www.hamfmfg.com

All dimensions in inches unless specified otherwise

Quality Enclosures. Service Excellence.