

PB Series Inner Panel *PBP Serie*

! **Nota:** Esta línea de productos ha sido descatalogada como serie en stock. La información es sólo para referencia. Para obtener asistencia sobre soluciones alternativas, **contacte con Hammond aquí** o llame al EE.UU. (716) 630-7030, Canadá e Internacional (519) 822-2960.

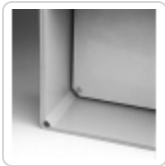

- Available in steel or unfinished aluminum.
- 14 gauge steel panels are finished in white powder coating.
- Aluminum panels are 0.080" (2.03 mm) unfinished.
- Hardware to mount inner panel is included with PB series enclosures.

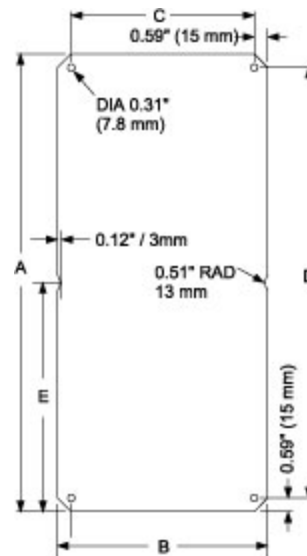

Steel Panel Part No.	Aluminum Panel	Fits PB Enclosure	A	B	C	D	E
PBP2718	PBPA2718	PB271818	9.06	5.51	4.33	7.88	-
PBP2727	PBPA2727	PB272718	9.06	9.06	7.88	7.88	-
PBP3627	PBPA3627	PB362718	12.60	9.06	7.88	11.42	-
PBP5427	PBPA5427	PB542718	19.69	9.06	7.88	18.51	9.84
PBP5436	PBPA5436	PB543618	19.69	12.60	11.42	18.51	9.84

Datos sujetos a cambios sin previo aviso.

