

1485V - SERIES

BUL10116

REV. C

ASSEMBLY INSTRUCTIONS FOR 1485V SERIES SWIVEL NIPPLE

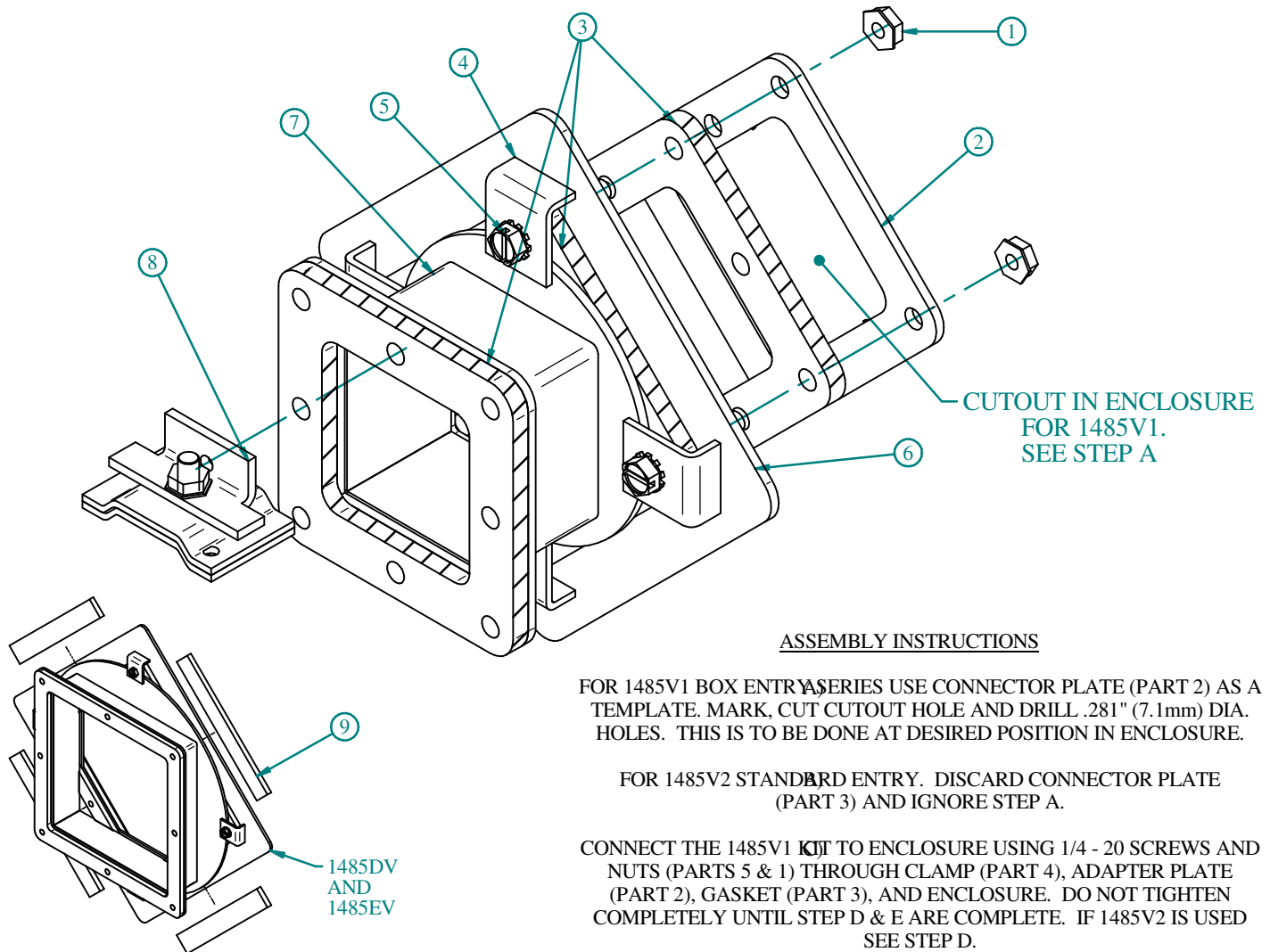

ASSEMBLY INSTRUCTIONS

FOR 1485V1 BOX ENTRY SERIES USE CONNECTOR PLATE (PART 2) AS A TEMPLATE. MARK, CUT CUTOUT HOLE AND DRILL .281" (7.1mm) DIA. HOLES. THIS IS TO BE DONE AT DESIRED POSITION IN ENCLOSURE.

FOR 1485V2 STANDARD ENTRY. DISCARD CONNECTOR PLATE (PART 3) AND IGNORE STEP A.

CONNECT THE 1485V1 KIT TO ENCLOSURE USING 1/4 - 20 SCREWS AND NUTS (PARTS 5 & 1) THROUGH CLAMP (PART 4), ADAPTER PLATE (PART 2), GASKET (PART 3), AND ENCLOSURE. DO NOT TIGHTEN COMPLETELY UNTIL STEP D & E ARE COMPLETE. IF 1485V2 IS USED SEE STEP D.

CONNECT THE BODY (PART 7) TO THE FLANGE ON THE MATING WIREWAY USING 1/4 - 20 X .75 HEX HD. SCREWS AND 1/4 - 20 KEP NUTS (PARTS 5 & 1) PROVIDED. IF 1485V2 IS USED IGNORE STEP C AND ASSEMBLE USING 1/4 - 20 HARDWARE THROUGH CLAMP (PART 4), ADAPTER PLATE (PART 2), GASKET (PART 3) AND MATING WIREWAY.

SLIP ANGLE SEALING BRACKET (PART 8) INTO MATING WIREWAY AND FASTEN TO THE FLANGE ON SWIVEL BODY USING 1/4 - 20 HARDWARE. IF 1485V2 KIT IS USED, ASSEMBLE THE SECOND SEALING BRACKET TO MATING WIREWAY AND THE ADAPTER PLATE (PART 6).

ONCE THE SWIVEL BODY AND ADAPTER PLATES ARE ALIGNED TO MATING COMPONENTS. TIGHTEN THE CLAMPS DOWN TO FIX THE POSITION OF THE SWIVEL ASSEMBLY.

APPLY EXTRA STRIPS OF GASKET (PART #9) TO COVER OPENINGS WHEN NIPPLE IS TURNED 45° ON 1485DV & 1485EV SWIVEL NIPPLES ONLY.

PART #	QTY.	DESCRIPTION
1	5 OR 8	1/4 - 20 KEP NUT
2	1	CONNECTOR PLATE (1485V1)
3	3	SOLID FLANGE GASKET
4	4	CLAMPS
5	4 OR 7	1/4 - 20 X 3/4 HEX CAP SCREW
6	1	ADAPTER PLATE
7	1	1485 V SWIVEL NIPPLE BODY
8	1 OR 2	ANGLE SEALING PLATE
9	4	GASKET (D & E ONLY IF NEEDED)

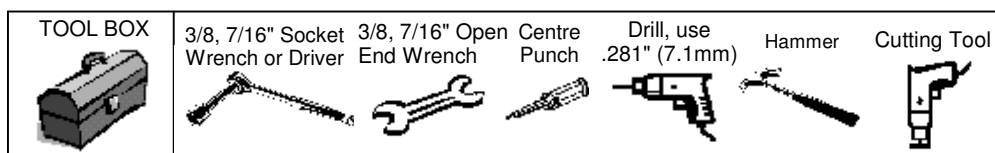

HAMMOND
MANUFACTURING™
ENCLOSURES