

# 1487V - SERIES

BUL10117

REV. B

## ASSEMBLY INSTRUCTIONS FOR 1487V SERIES SWIVEL NIPPLE

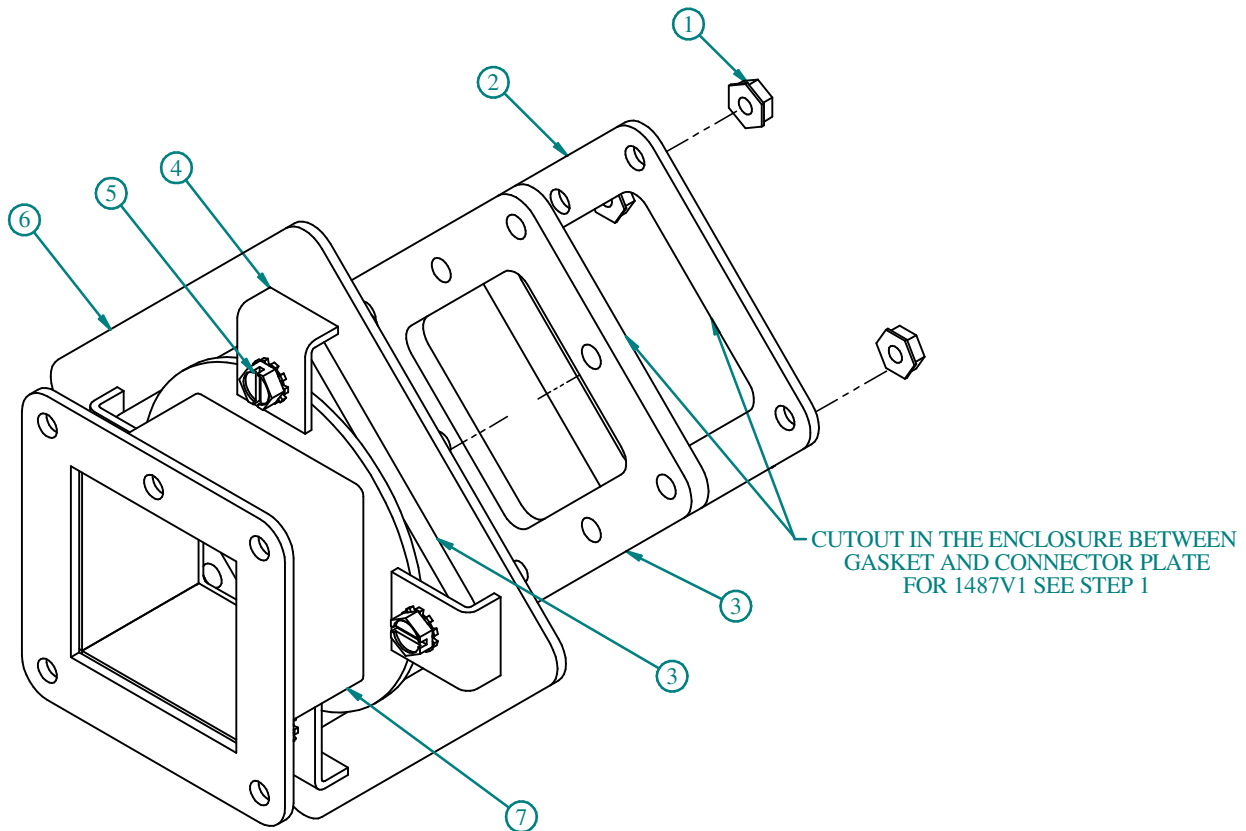

### ASSEMBLY INSTRUCTIONS

1. For 1487V1 box entry series use connector plate (Part 2) as a template. Mark cut/cut cuout hole and drill 0.284" (7.1mm) dia. holes. This is to be done at desired position in enclosure.
2. For 1487V2 standard entry. Discard connector plate (Part 3) and ignore step 1.
3. Connect the 1487V1 kit to the enclosure using 1/4-20 screws and nuts (Parts 5 & 1) through clamp (Part 4), adaptor plate (Part 2), gasket (Part 3) and enclosure. Do not tighten completely until Step 4 is complete. If 1487V2 is used see Step 3.
4. Connect the body (Part 7) to the flange on the mating wireway using 1/4-20 Hex head screws and Kep nuts (Parts 5 & 1) If 1487V2 is used ignore Step 3 and assemble using 1/4-20 hardware through clamp (Part 4), adaptor plate (Part 2), gasket (Part 3) and mating wireway.
5. Once the swivel body and adaptor plates are aligned to the mating components, tighten the clamps down to fix the position of the swivel assembly.

PART #	QTY.	DESCRIPTION
1	5 or 8	1/4 - 20 KEP NUT
2	1	CONNECTOR PLATE (1487V1)
3	1 or 2	SOLID FLANGE GASKET
4	4	CLAMPS
5	4 or 7	1/4 - 20 X 3/4 HEX CAP SCREW
6	1	ADAPTER PLATE
7	1	1487 V SWIVEL NIPPLE BODY

