

THK3 HANDLE KIT

FOR DOUBLE DOOR WITH CENTRE CHANNEL AND FOR SINGLE DOOR ENCLOSURES

BUL10174

REV. F

ASSEMBLY INSTRUCTIONS

A) MARK AND DRILL DOOR TO DIMENSIONS SHOWN IN DRILLING DETAIL BELOW. THE 2.172/55.2mm DIM. IS FROM I/S DOOR OPENING ON ENCLOSURE.

HANDLE HOLES ARE DRILLED ON CENTRE LINE OF DOOR, VERTICALLY.

B) MOUNT HANDLE (PART 1) USING 4mm SCREWS, LOCKWASHERS AND #10 FLAT WASHERS (PARTS 17, 3, 2) IF DOOR THICKNESS IS 12GA OR HEAVIER.

DISCARD #10 FLAT WASHER. WIND 10mm NUT (PART 16) TO BOTTOM OF THREADED SHAFT.

C) SLIP STRAIGHT CAM (PART 9) FOR DOUBLE DOOR OR OFFSET CAM (PART 8) FOR SINGLE DOOR ENCLOSURE OVER SHAFT, LATCH FACING OUT 90 DEGREES

TO HANDLE. SLIP ROLLER CAM BRACKET (PART 12) OVER SHAFT AS SHOWN AND TIGHTEN DOWN WITH 10mm NUT AND LOCK WASHER (PARTS 16, 6)

D) AFTER DRILLING TOP AND BOTTOM .390(9.9mm DIA. HOLES ON DOOR, MOUNT SCREWS, WELD NUTS, SPRINGS, WASHERS (PARTS 13, 14, 15, 7) AS SHOWN. PLACE LOCK RODS (PART10) ONTO SCREW AND MOUNT USING LOCKNUT AND WASHER (PARTS 5, 7) AS SHOWN. IF LOCKRODS NEED TO BE CUT DOWN SEE STEP E.

E) CUT LOCK RODS (PART10) TO DESIRED LENGTH. SEE NOTE: 1

F) ADJUST ALIGNMENT OF LOCKRODS BY TURNING 3/8-16 LOCK NUT (PART 5) TO ACHIEVE DESIRED DOOR COMPRESSION AND LOCKING ACTION.

DOOR COMPRESSION DETAIL

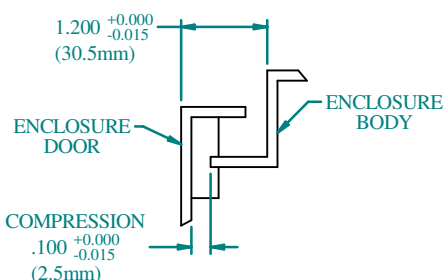

NOTE: 1
LOCKRODS ARE SUPPLIED TO SUIT
79.31" OPENING IN ENCLOSURE HEIGHT.
FOR ENCLOSURE LESS THAN 79.31"
OPENING, CUT EACH ROD 1/2 THE
DIFFERENCE OFF THE END.
eg. ENCLOSURE OPENING IS 61.31" HIGH
(79.31 - 61.31 = 18), 18/2 = 9".
THEN 9" WOULD BE CUTOFF EACH ROD,
REDRILL .281Dia. HOLE, LOCATIONS AS
PER CUT OFF END.

PART #	DESCRIPTION	QTY.
1	HANDLE	1
2	WASHER FLAT #10 ZP	2
3	WASHER #10 LOCK ZP	4
4	SCREW 10-32 X 3/8"	2
5	NUT LOCK 3/8	2
6	WASHER LOCK 3/8	1
7	WASHER FLAT 5/16 ZP	4
8	OFFSET CAM	1
9	LOCK ROD	2
10	NUT SHOULDER	2
11	ROLLER BRACKET	1
12	SCREW ROUND 3/8-16 X 1/5"	2
13	NUT HEX 3/8 ZP	2
14	SPRING	2
15	NUT HEX JAM M10	2
16	SCREW PAN M4 X 10	2
17	GASKET	1

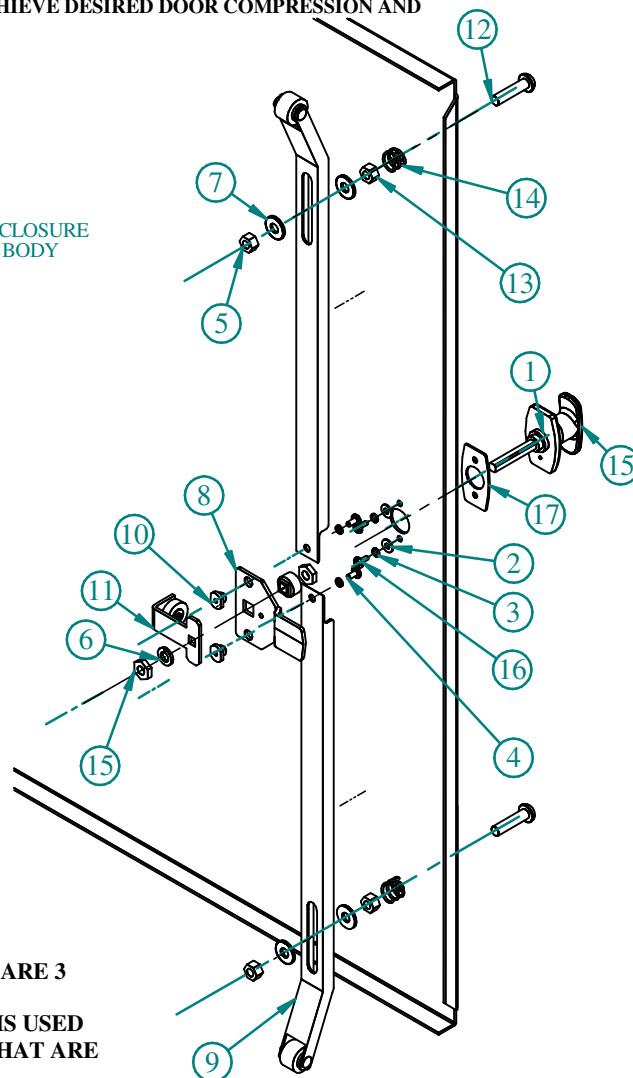

NOTE: THESE KITS ARE 3
POINT
LATCHING SYSTEMS USED
ON ENCLOSURES THAT ARE
60" AND HIGHER.

**HAMMOND
MANUFACTURING™
ENCLOSURES**

TOOL BOX	Slot Head Screw Driver	Centre Punch	Drill, use .218(5.5mm), .390(9.9mm)	Hammer	9/16" Socket Wrench	9/16" & 17mm Open End Wrench	Tape Measure

DOOR DRILLING TEMPLATES

BUL10174

REV. F

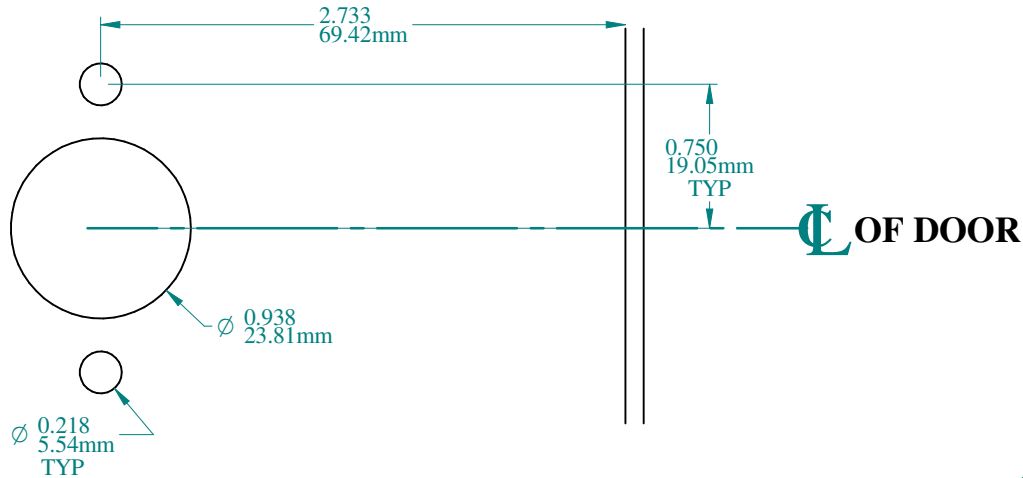

HANDLE
(DRILLING TEMPLATE)

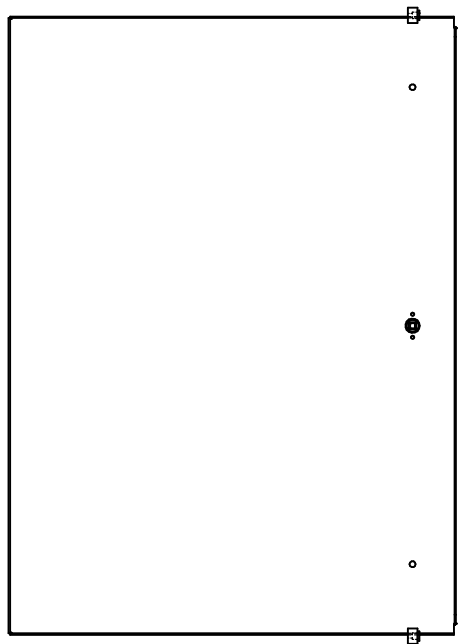

DOOR
(INSIDE VIEW)

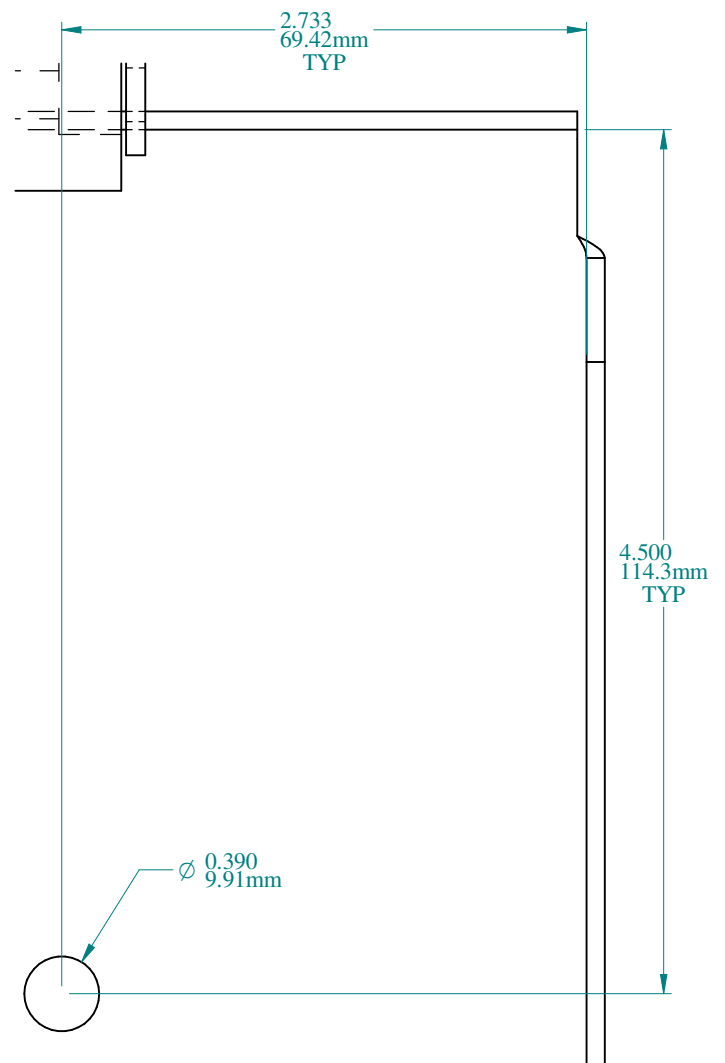

SCREW HOLE
TOP/BOTTOM
(DRILLING TEMPLATE)

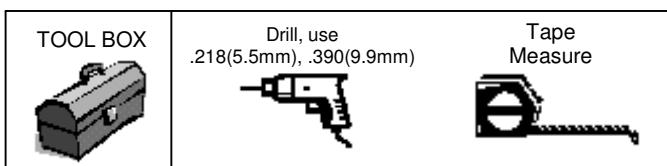

LOCK ROD MODIFICATION DETAIL

BUL10174

REV. F

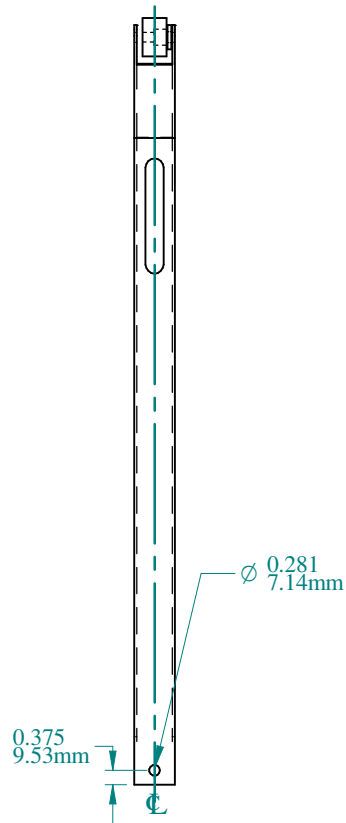

FRONT VIEW
(DRILL DETAIL)

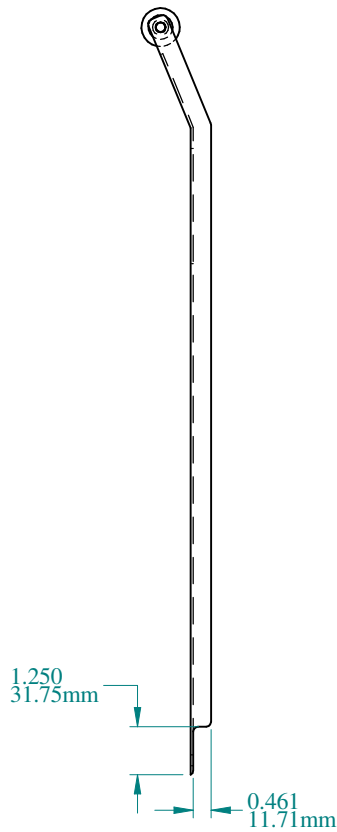

SIDE VIEW
(NOTCHING DETAIL)

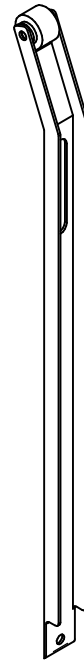

ISOMETRIC VIEW

NOTE: THESE KITS ARE 3
POINT
LATCHING SYSTEMS USED
ON ENCLOSURES THAT ARE
60" AND HIGHER.

HAMMOND
MANUFACTURING™
ENCLOSURES

TOOL BOX	Drill, use .218(5.5mm), .390(9.9mm)	Cutting Tool	Tape Measure
