

# FLK - SERIES

## ASSEMBLY INSTRUCTIONS FOR LIGHT MOUNTING KIT

BUL10212  
REV. D  
PAGE 1 OF 2

### ASSEMBLY INSTRUCTIONS:

Remove plastic light cover.

Mount light housing using one of the following 3 methods: Step 1 or 2 or 3

- 1) Attach optional magnetic mounting strip (item 3) with magnetic strips facing up to light housing. Secure using 10-32 screws and kep nuts (items 4 & 5) thru mounting holes in light housing. Place on desired surface in enclosure.
- 2) Using mounting holes in light housing as template, mark drill location in top of enclosure. Drill .281/ 7mm dia. holes and secure using 1/4-20 hardware and sealing washers.
- 3) Mount light housing onto existing C channel in top of enclosures that are so equipped. Secure using 1/4-20 hardware and spring nuts.

Place Fluorescent tube (not provided) into light fixture and replace light cover.  
Connect electrical cord as per local electrical code

### ASSEMBLY NOTES REMOTE DOOR SWITCH:

- A) Remote door switch bracket (item 2) can be mounted to underside flange of enclosure top. Mount in desired location of door opening: Drill .203 / 5mm dia. holes at 2.0" / 50.8mm centers mount slotted bracket using 10-32 screws and kep nuts (items 4 & 5)
- B) Attach snap in door switch and adjust switch and bracket to activate on I/S door surface. Tighten screws and nuts on slotted bracket.
- C) Connect power as per local electrical code. Note schematic for remote switch to fluorescent light kit.

### LIGHT KIT AND REMOTE DOOR SWITCH

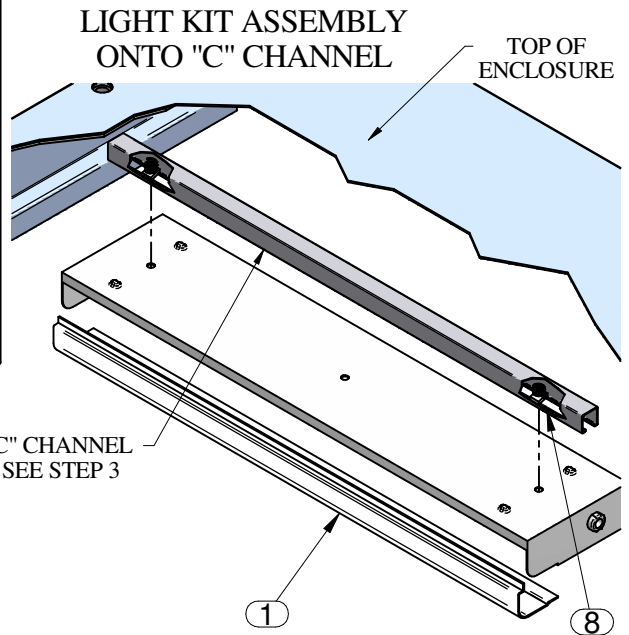
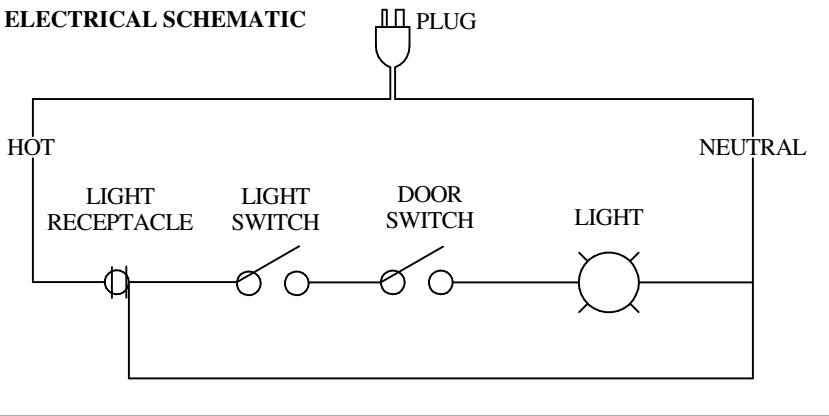
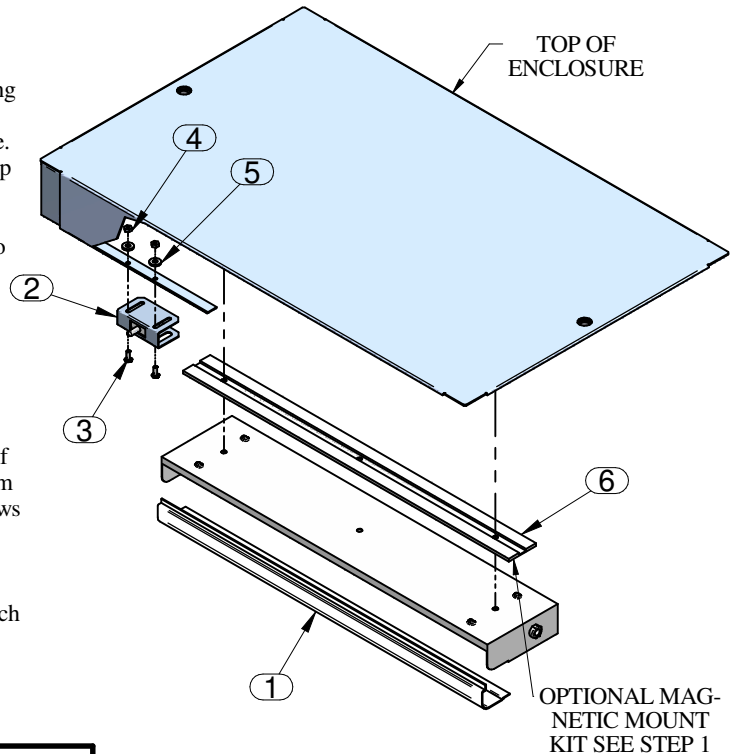

PARTS LIST		
ITEM No.	DESCRIPTION	QTY
1	FLK LIGHT KIT	1
2	REMOTE DOOR SWITCH *	1
3	10-32 SCREW *	4*
4	10-32 KEP NUT *	4*
5	SEALING WASHER *	4*
6	MAGNETIC MTG STIP	1
7	1/4-20 SCREW	2
8	1/4-20 SPRING NUT	2
9	SLOTTED BRACKET *	1*

\* Supplied with FLKDS

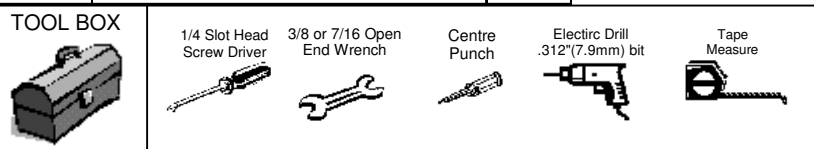

**Français**

Pour tous les détails sur nos produits, svp veuillez consulter notre site [www.hammondmf.com](http://www.hammondmf.com)  
 Data subject to change without notice. Isometric drawing not to scale.  
 Les données sont sujettes à changement sans préavis.

**HAMMOND MANUFACTURING.**  
[www.hammondmf.com](http://www.hammondmf.com)

RoHS

PART NO. BUL10212\_REV\_D

### C2 AND C4 SERIES ASSEMBLY NOTES FOR REMOTE DOOR SWITCH:

- A) Mounting bracket (item 9) can be mounted to inside flange of enclosure top. Mount in desired location of door opening: Drill .203 / 5mm dia. holes at 1 3/4" / 45.5mm centers mount slotted bracket using 10-32 screws, flat washers and kep nuts (items 3, 4 & 5)
- B) Remote door switch bracket (item 2) can be mounted to slotted bracket using 10-32 screws, flat washers and kep nuts (items 3, 4 & 5)
- C) Attach snap in door switch (item 2A) and adjust switch and bracket to activate on I/S door surface. Tighten screws and nuts on slotted bracket.
- D) Connect power as per local electrical code. Note schematic for remote switch to fluorescent light kit on sheet 1.

### LIGHT KIT AND REMOTE DOOR SWITCH

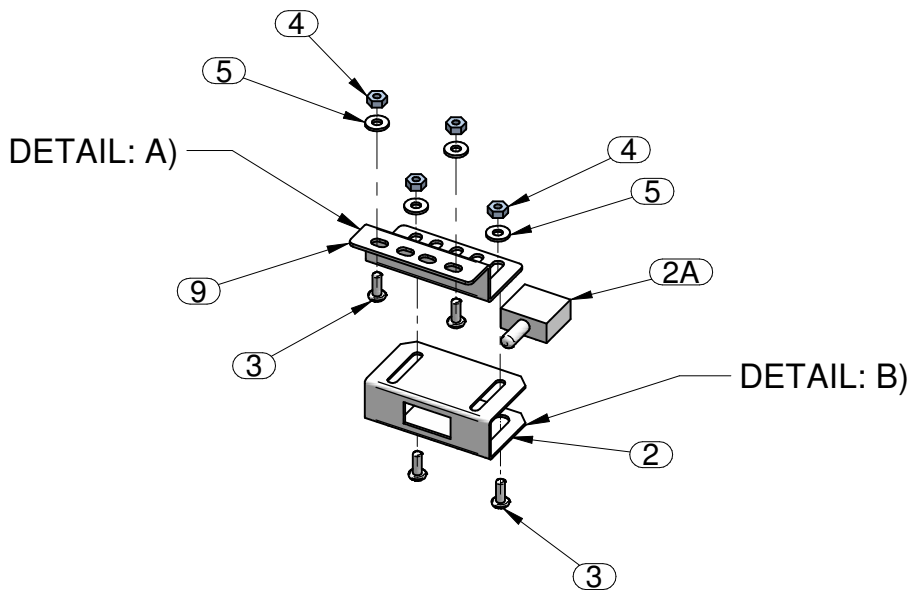
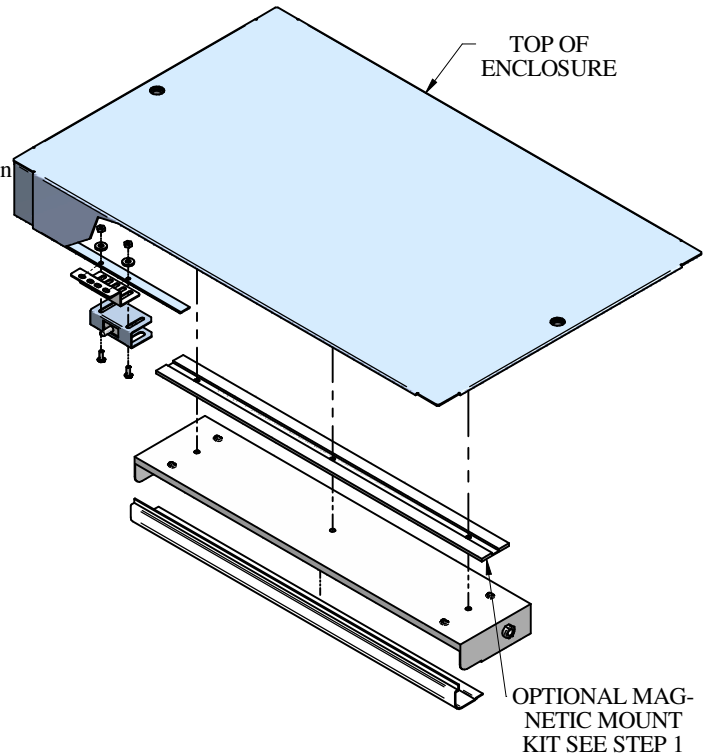

**FLKDS**  
REMOTE DOOR SWITCH KIT  
FOR C2 AND C4 SERIES RACKS