

HPB- SERIES

BUL10426

REV. A

ASSEMBLY INSTRUCTIONS FOR HPB - SOLID PLINTH

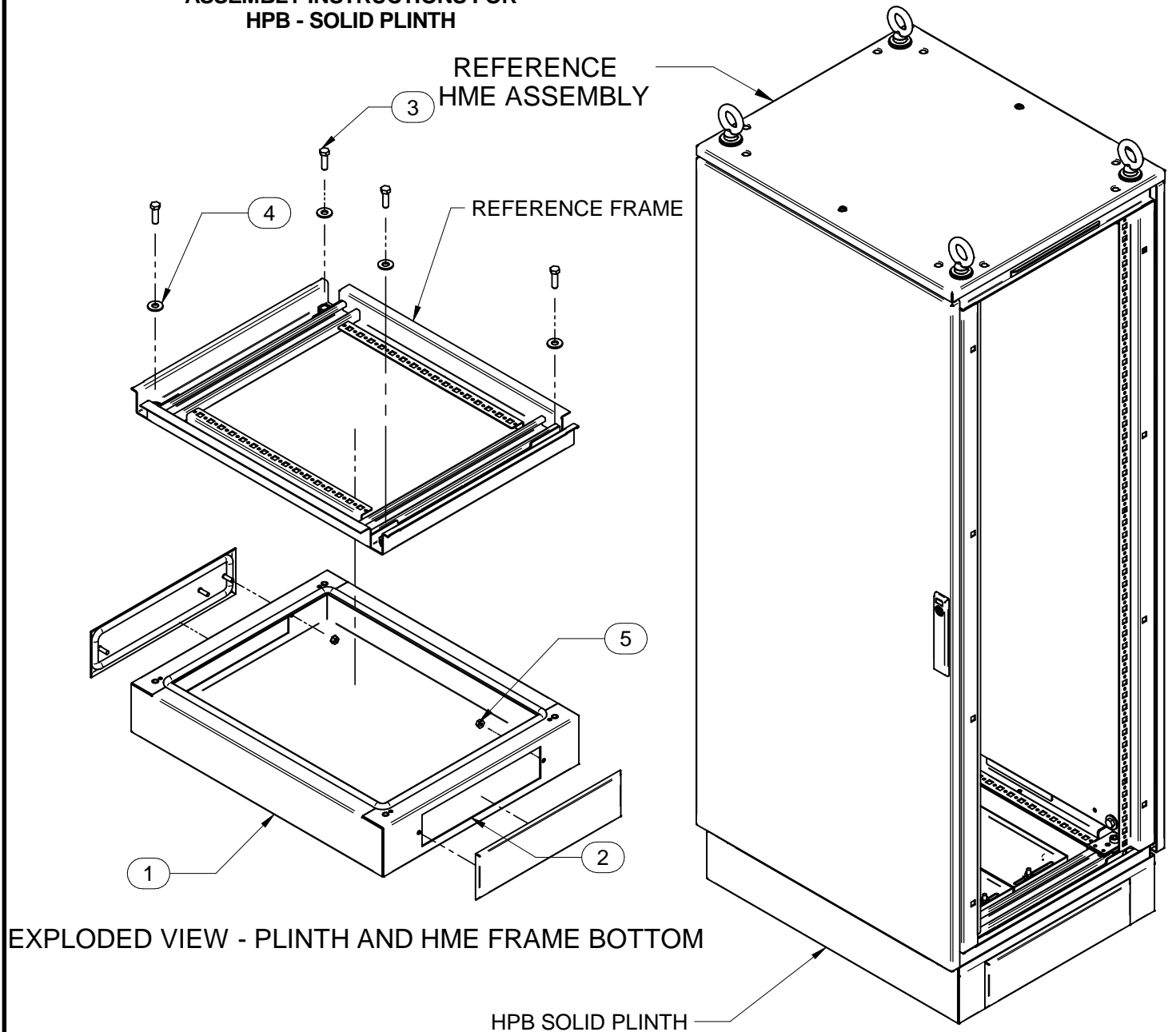

EXPLODED VIEW - PLINTH AND HME FRAME BOTTOM

ASSEMBLY INSTRUCTIONS:

- A) Lift and support HME assembly.
- B) Place the plinth in the desired orientation, and lower HME assembly to within 1/4".
- C) Align cabinet to plinth by installing one screw and washer in each corner as shown above. Once aligned, lower HME assembly and tighten all screws.

HPB PARTS LIST

ITEM No.	DESCRIPTION	QTY
1	HPB SOLID PLINTH	1
2	HPB GLAND PLATE	2
3	3/8 X 1.25 HEX HEAD SCREW	4
4	3/8 WASHER	4
5	1/4 - 20 NUT	4

TOOL BOX



9/16" Socket
Wrench



3/8" Socket
Wrench



**HAMMOND
MANUFACTURING™**
www.hammondmfg.com