

# RHN4 - SERIES

**BUL87515**  
REV. A

## ASSEMBLY INSTRUCTIONS FOR

ALL SIZES OF: RHN4GY, RHN4LG, RHN4SS, RHN4S16, RHN4SSFDA, RHN4S16FDA

### PARTS LIST:

- \* 1/4 - 20 X 3/4 HEX SCREW - 4PCS
- \* 1/4 - 20 KEP NUT - 4 PCS
- \* M5 X 16 CAP SCREW - 2 PCS
- \* RAINHOOD - 1 PC

- \* 1/4" WASHER - 4 PCS
- \* M5 X 25MM THUMB SCREW - 2 PCS
- \* DEFLECTOR - 1 PC
- \* FRAME - 1 PC

- 1) Filter/fan to be installed before UL Type 12 / 3R / 4 / 4X rain hood is installed. Refer to filter fan installation manual.

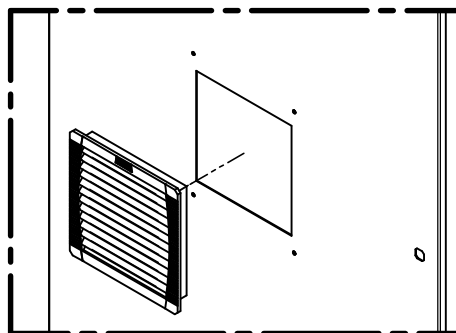

- 2) Using frame piece, mark and drill (4x) 1/4" holes around filter fan in enclosure wall, refer to drill detail below. Install frame piece and spray deflector on the outside of the enclosure as shown with 1/4-20 hex screws. Using 1/4" dome sealing washer against the inside enclosure wall, tighten with 1/4-20 kept nut until sealing washer is flat.

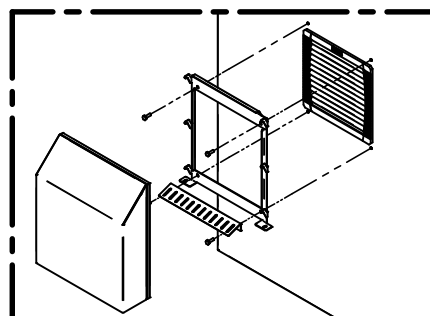

DIMENSIONAL CHART - INCHES (MM)

| PART # (GY/LG/SS/FDA/S16) | A            | B            | C            | D            |
|---------------------------|--------------|--------------|--------------|--------------|
| RH20000N4                 | 4.921 (125)  | 4.921 (125)  | 7.050 (179)  | 5.076 (129)  |
| RH30000N4                 | 6.969 (177)  | 6.969 (177)  | 9.291 (236)  | 7.323 (186)  |
| RH40000N4                 | 8.778 (223)  | 8.778 (223)  | 11.260 (286) | 9.291 (236)  |
| RH60000N4                 | 11.457 (291) | 11.457 (291) | 13.949 (354) | 12.071 (307) |

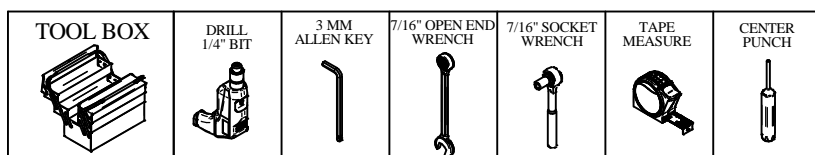
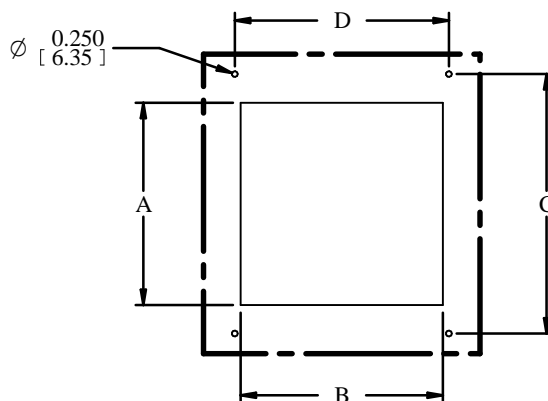

**HAMMOND**  
**MANUFACTURING™**  
[www.hammondmfg.com](http://www.hammondmfg.com)

# RHN4 - SERIES

**BUL87515**  
REV. A

ASSEMBLY INSTRUCTIONS FOR  
RHN4GY, RHN4LG, RHN4SS, RHN4S16, RHN4SSFDA, RHN4S16FDA

- 3) Place rain hood cover onto mounted frame by lining up cover slots with the 6 mounting hooks on the frame piece.

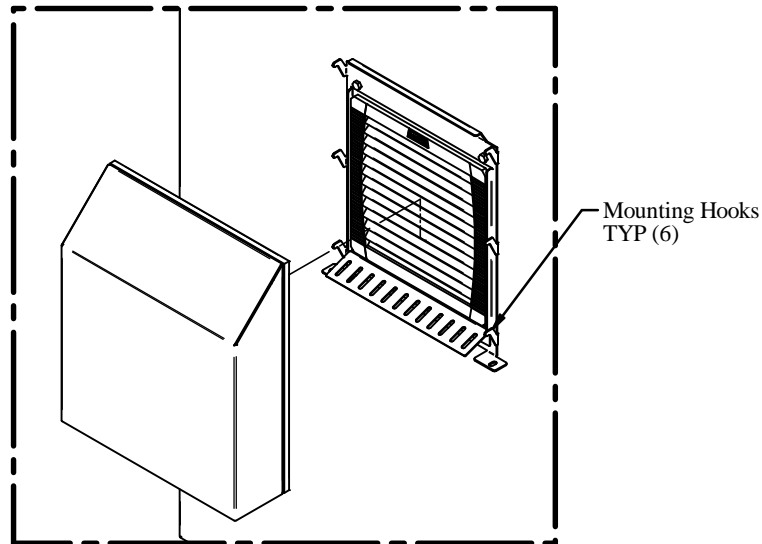

- 4) Insert wing screws or Allen fasteners through bottom tabs in frame and into the Pem-nuts on the cover. Tighten wing screw fasteners down by hand (standard) or with a 3mm allen key (security). As fasteners are tightened, cover will be pulled down onto the frame and the cover gasket will be compressed against the outer enclosure wall, creating a seal. Tighten until tabs on cover contact tabs on mounting frame (approximately 5 newton-meters torque).

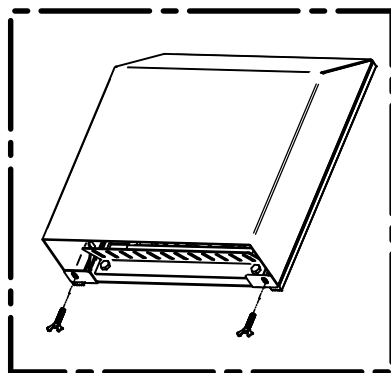

Tool-less wing screw fasteners (standard)

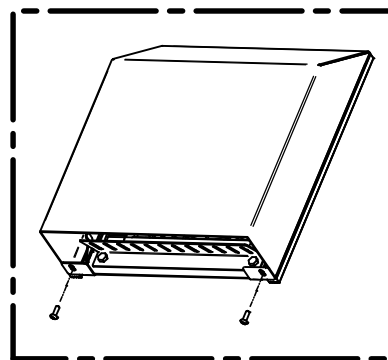

Allen fasteners (security option)

| TOOL BOX | DRILL | 3 MM ALLEN KEY | 7/16" OPEN END WRENCH | 7/16" SOCKET WRENCH | TAPE MEASURE | CENTER PUNCH |
|----------|-------|----------------|-----------------------|---------------------|--------------|--------------|
|          |       |                |                       |                     |              |              |

**HAMMOND**  
**MANUFACTURING™**  
[www.hammondmfg.com](http://www.hammondmfg.com)