

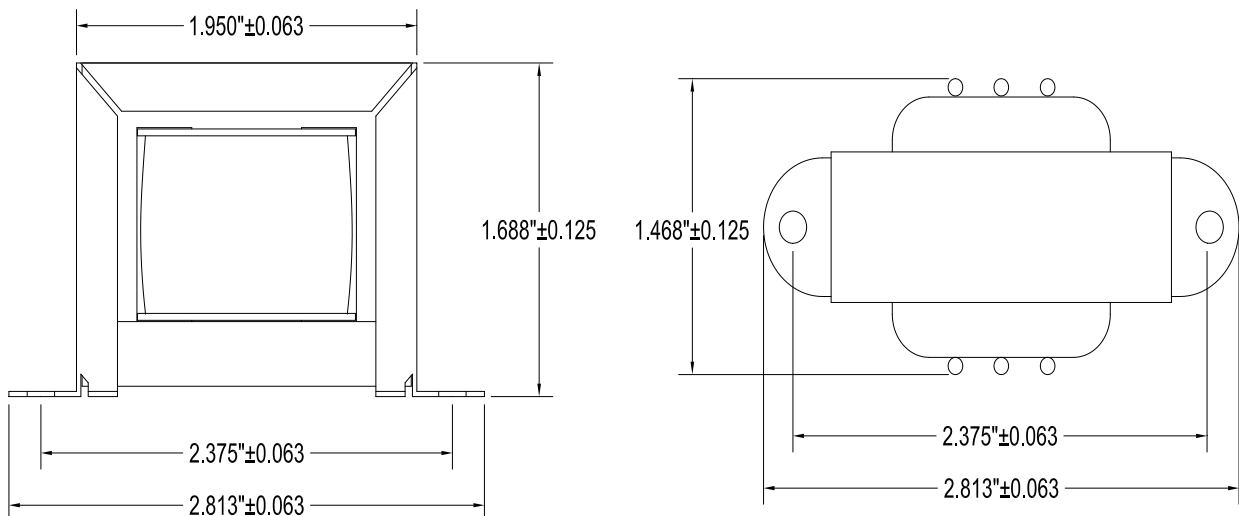

125ASE

UNIVERSAL SINGLE ENDED TUBE OUTPUT TRANSFORMER

-) Designed for general purpose or replacement use (not Hi-Fi), in single ended, tube output circuits.
-) Frequency response: 100 Hz. - 15 KHz at full rated power (see graphs for detailed response).
-) For full frequency response (20 Hz. to 20 KHz.) - see our 1627-1642 Series.
-) For push-pull output use, see our 125 Series.
-) Open style with minimum 12" long primary & secondary leads.
-) All sizes use butt stacked cores (using 29M6 steel) with an air gap, to reduce D.C. core saturation.
-) Primary impedance range from 2,500 to 10,000 Ohms.
-) Secondary impedance range from 4 to 32 Ohms.

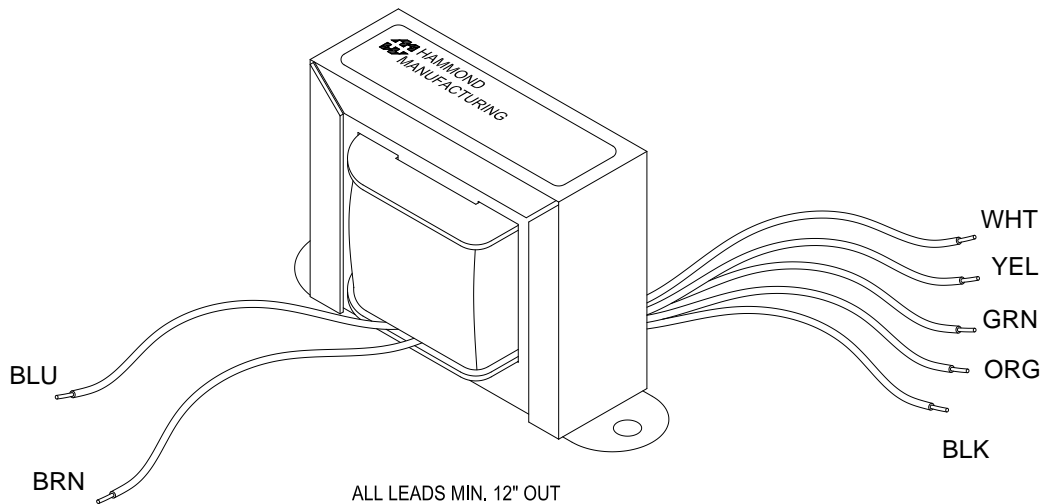

ELECTRICAL SPECIFICATIONS**

<u>Characteristic</u>	<u>Typical</u>
Input Impedance	2500 - 10000 \varnothing
Output Impedance	4/8/16/32 \varnothing
Output Power	3 Watts
Max. DC Bias	25 mA
Primary - DCR	
Blue - Brown	242 \varnothing
Secondary DCR	
Black - Orange	272 m \varnothing
Black - Green	366 m \varnothing
Black - Yellow	500m \varnothing
Black - White	700m \varnothing
Inductance @ 1.0 kHz, 1.0 V OC	
Primary - Blue - Brown	5.0 Hy
Sec - Black - Orange	3.0 mH
Sec - Black - Green	6.0 mH
Sec - Black - Yellow	12.2 mH
Sec - Black - White	24.5 mH
Impedance @ 1.0 kHz, 1.0 V OC	
Primary - Blue - Brown	28.8 K \varnothing
Sec - Black - Orange	18.1 \varnothing
Sec - Black - Green	36.4 \varnothing
Sec - Black - Yellow	73.3 \varnothing
Sec - Black - White	147.5 \varnothing
Frequency Response	See graphs for specific response, Typ. $\left\{ \begin{array}{l} 1.0\text{db from} \\ 100\text{Hz to } 15\text{KHz} \end{array} \right.$
Dielectric Strength	1500Vrms
Temperature Range	-40 To 105 \varnothing C

Schematic and Hook Up Data

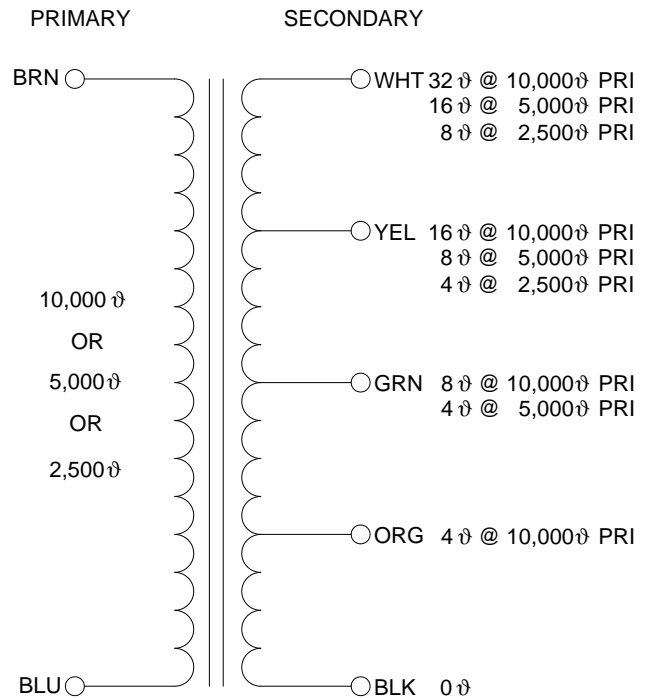

HAMMOND MANUFACTURING **125ASE**
 SINGLE ENDED AUDIO 3W 25mA DC
 PRI: 10,000; 5,000; 2,500 OHM
 SEC: 4, 8, 16, 32 OHM
 DATE CODE MADE IN CANADA

125ASE Frequency Response Rs=10k Ω

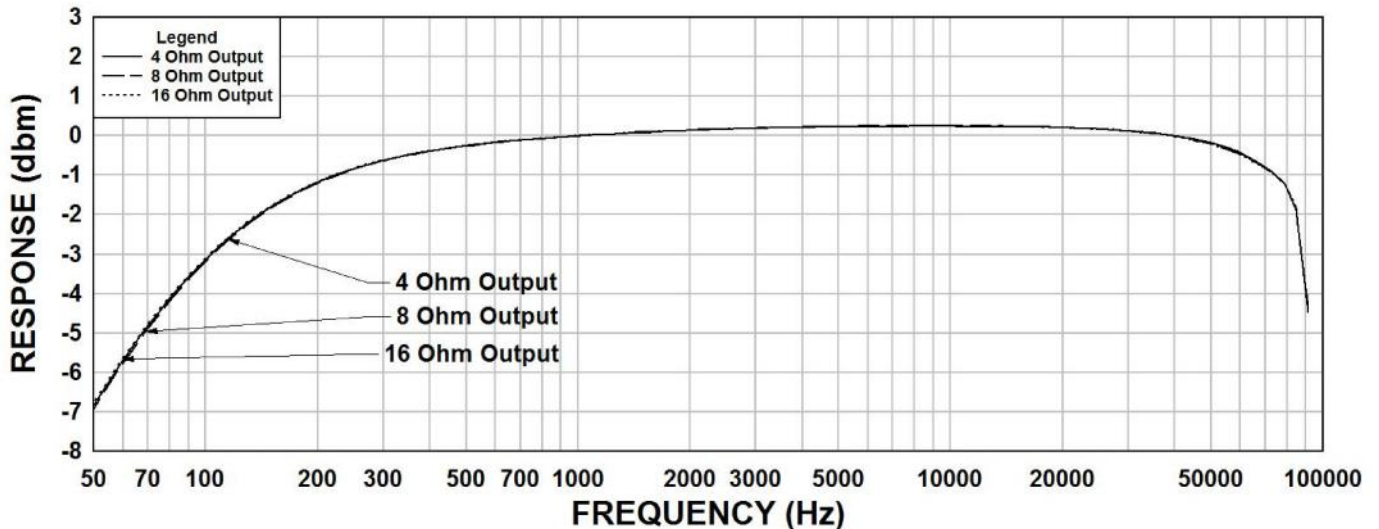

125ASE Frequency Response $R_s=5k\Omega$

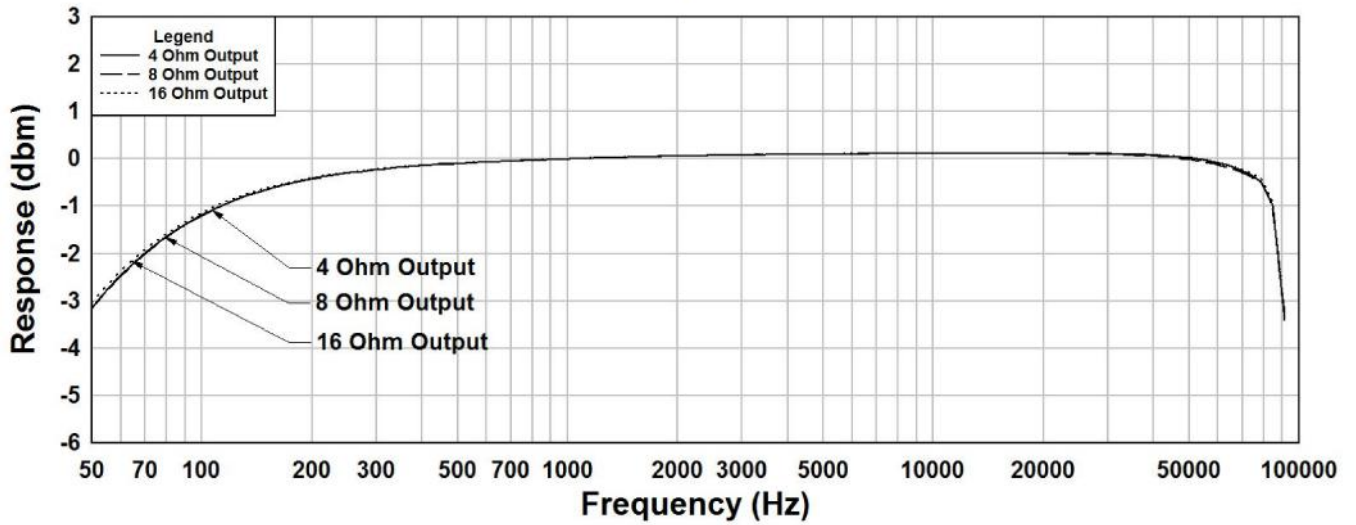

125ASE Frequency Response $R_s=2500\Omega$

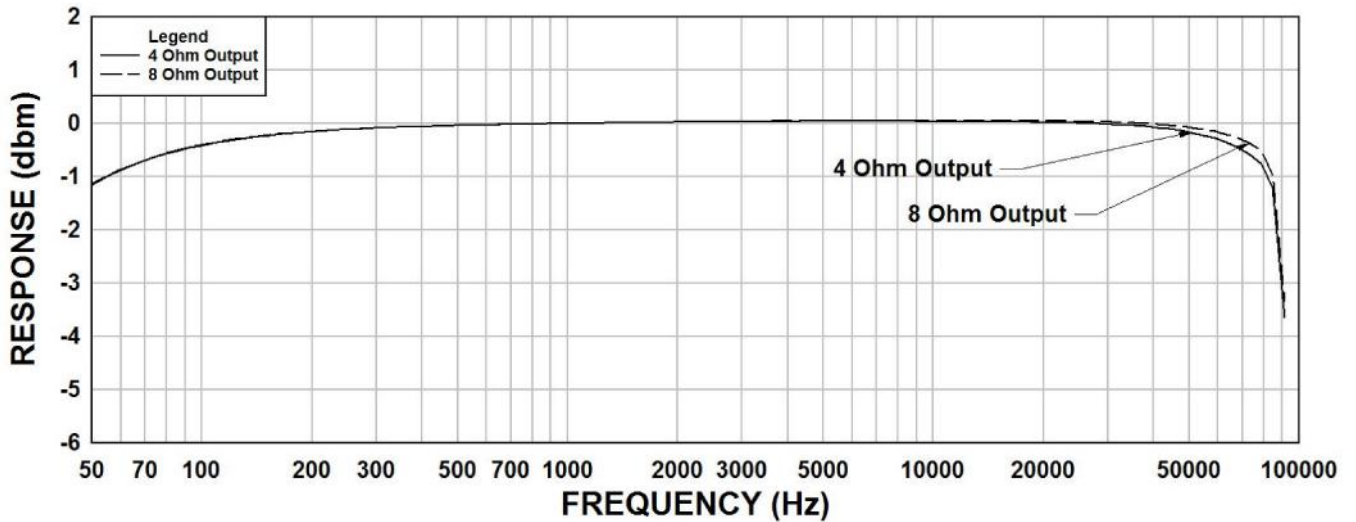

125ASE THD+N $R_s=10k\Omega$

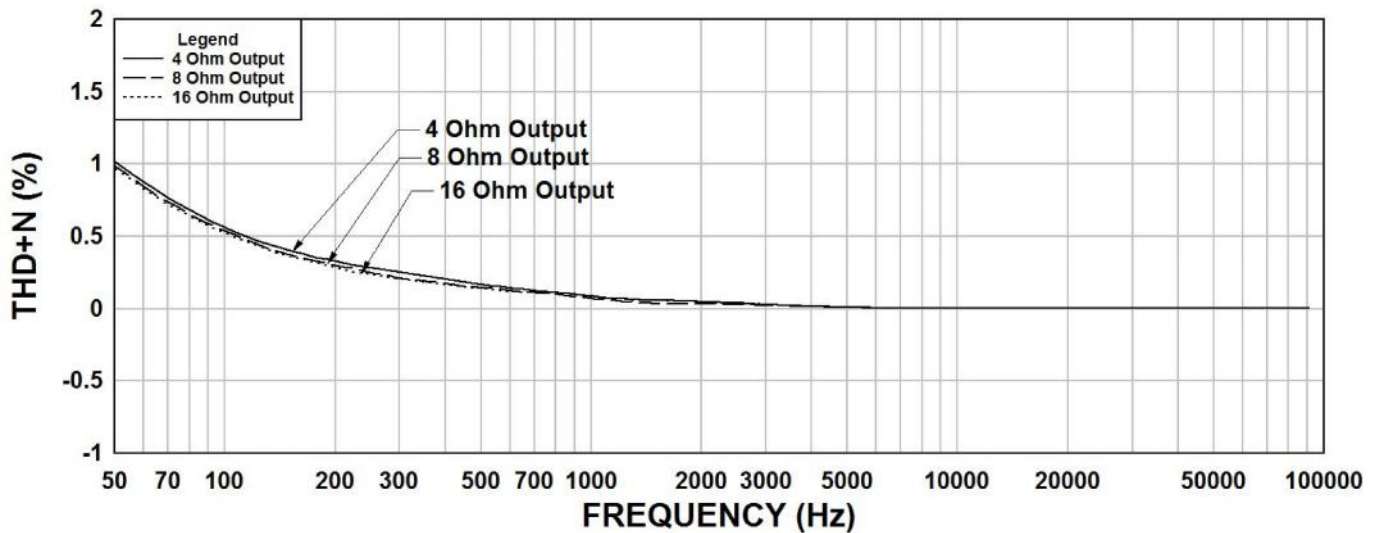

125ASE THD+N Rs=5kΩ

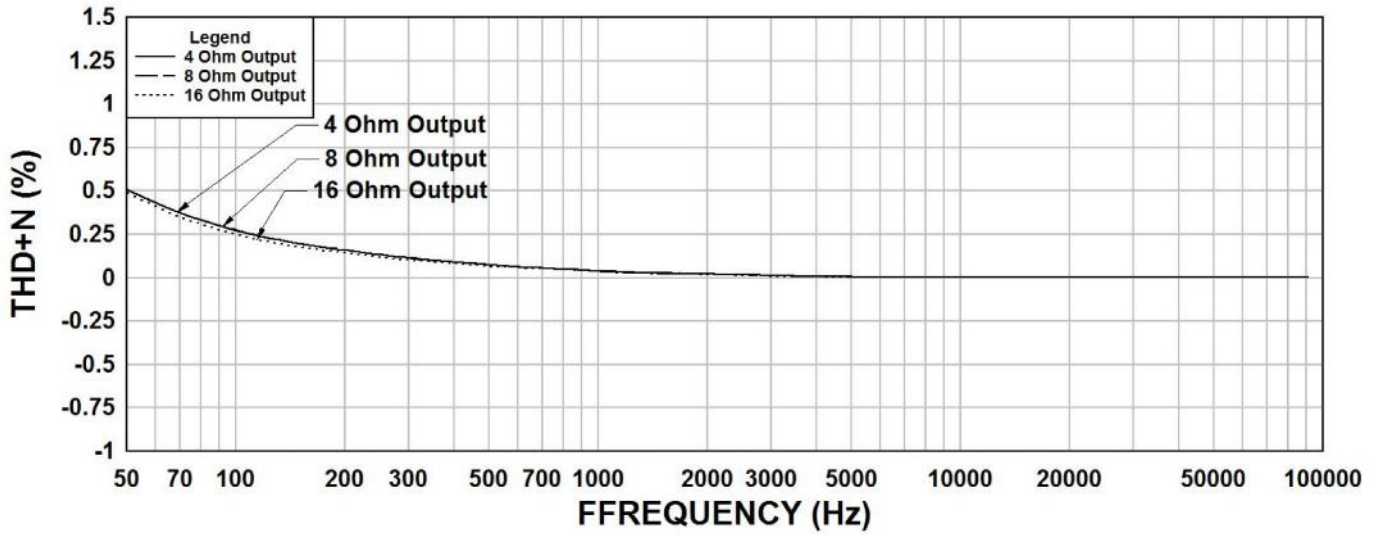

125ASE THD+N Rs=2500Ω

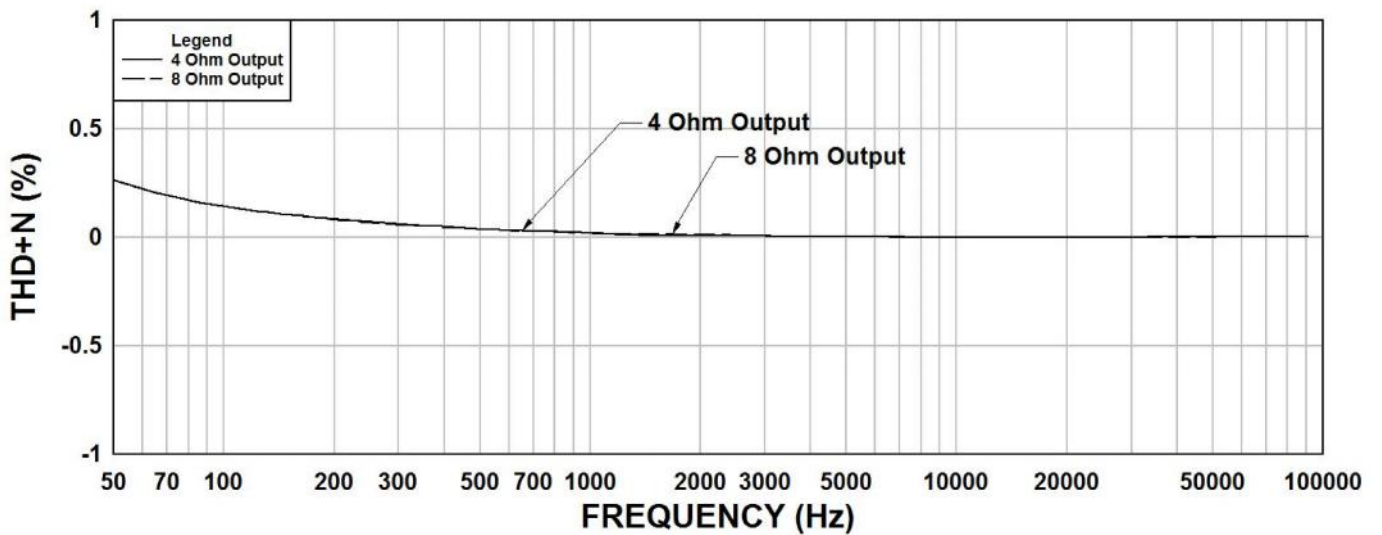

125ASE Phase Shift Rs=10kΩ

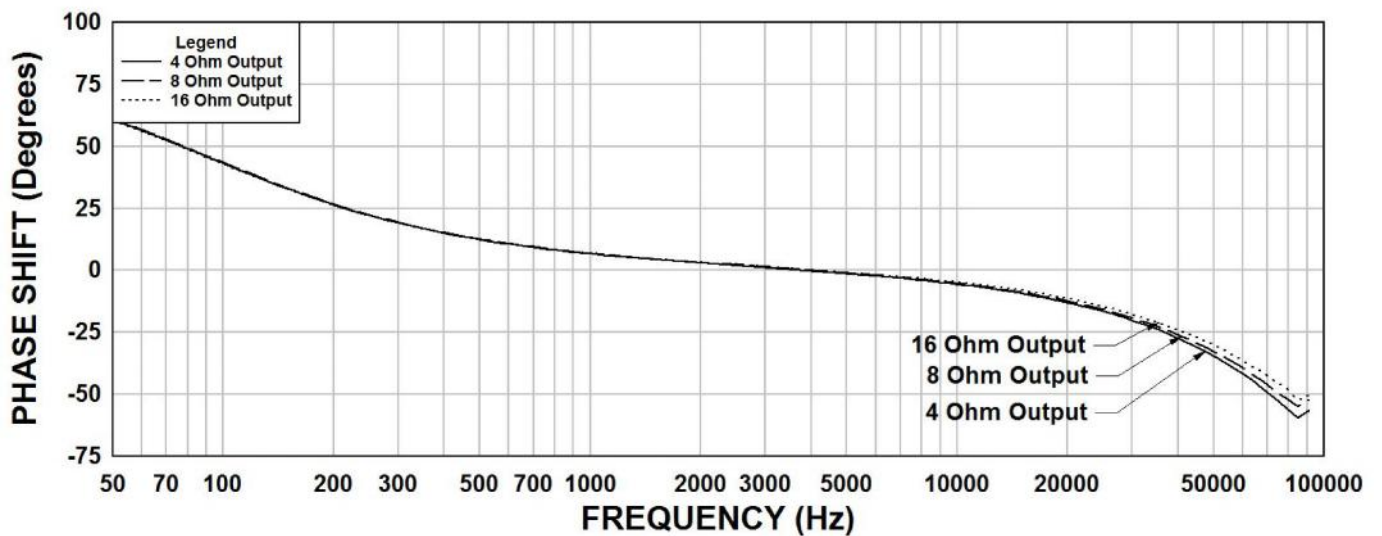

125ASE Phase Shift $R_s=5k\Omega$

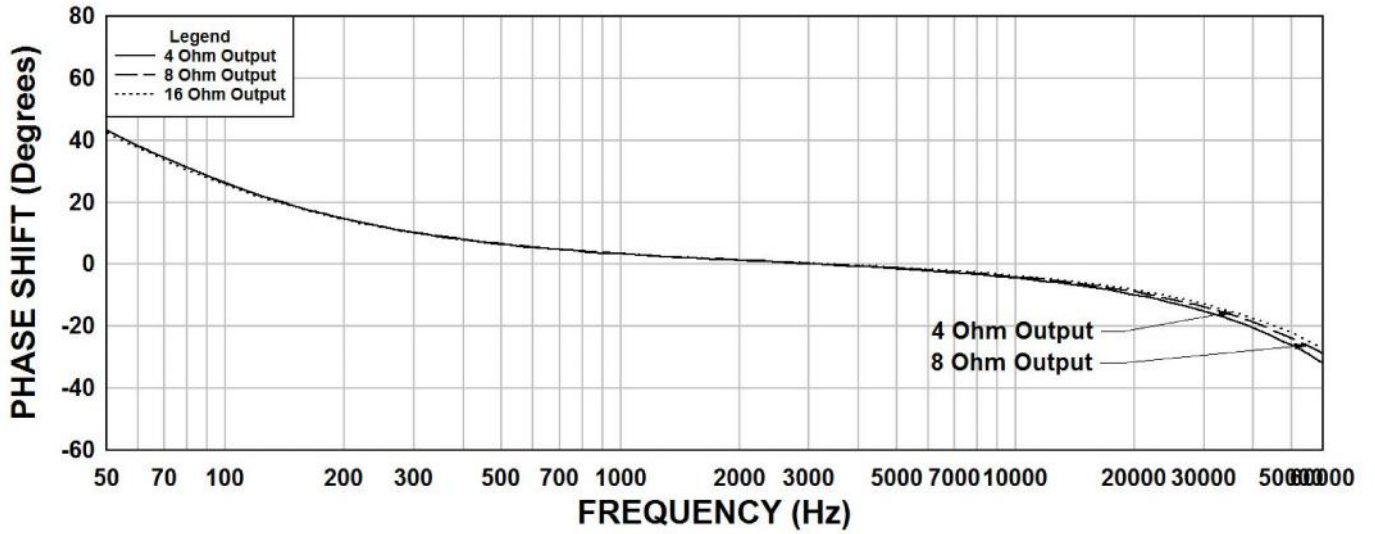

125ASE Phase Shift $R_s=2500\Omega$

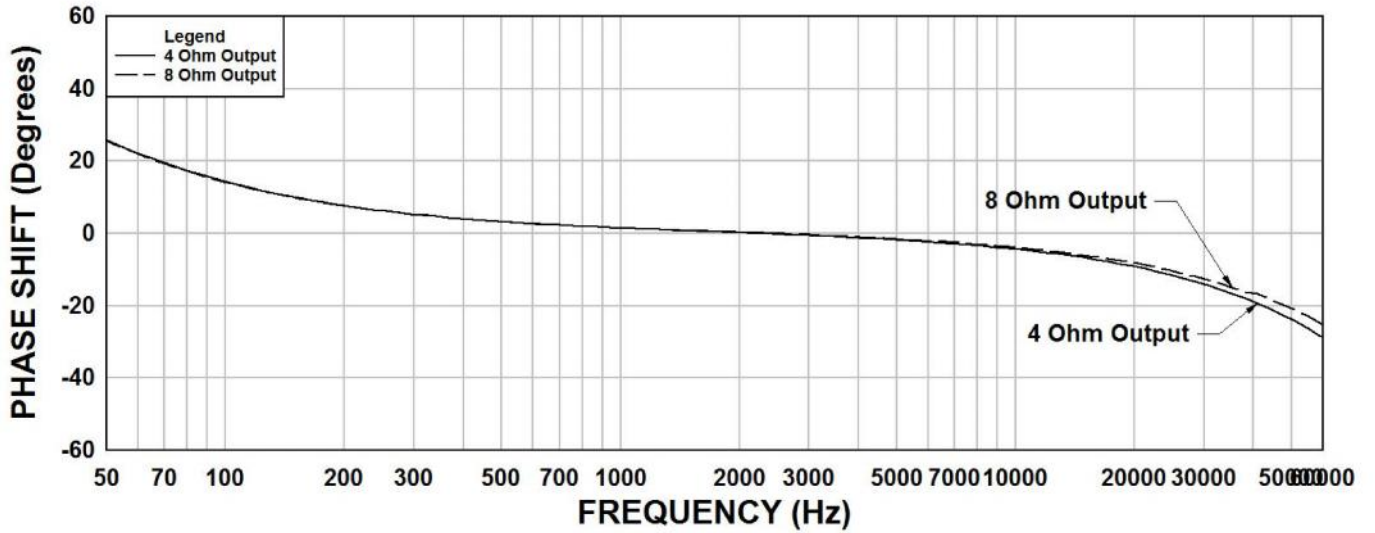

TYPICAL TEST CIRCUIT

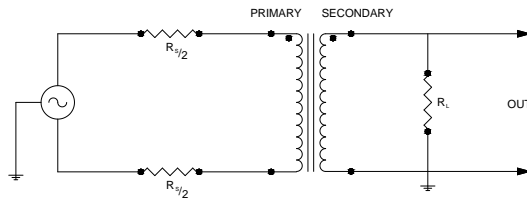

Measurement instruments
 Hp4192a impedance analyzer
 Hp3456a DVM
 Keithley 2002 DVM
 D scope series iii audio analyzer
 Wayne Kerr 3255B with a 3265B

* All graphs input level 20dbu.

** The results are typical and are subject to normal manufacturing and electrical tolerances.

This drawing and the information in it is the property of Hammond Manufacturing. It may not be reproduced, transmitted or used in any manner whatsoever without the written permission of Hammond Manufacturing. Data subject to change without notice.