

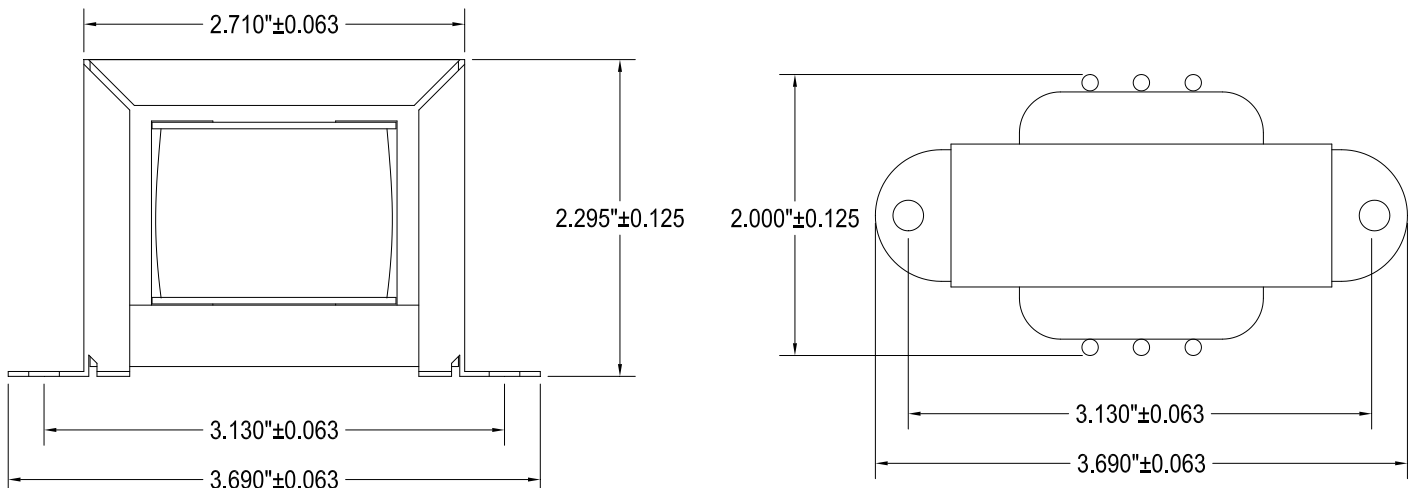

## 125CSE

### UNIVERSAL SINGLE ENDED TUBE OUTPUT TRANSFORMER

- ) Designed for general purpose or replacement use (not Hi-Fi), in single ended, tube output circuits.
- ) Frequency response: 100 Hz. - 15 KHz at full rated power (see graphs for detailed response).
- ) For full frequency response (20 Hz. to 20 KHz.) - see our 1627-1642 Series.
- ) For push-pull output use, see our 125 Series.
- ) Open style with minimum 12" long primary & secondary leads.
- ) All sizes use butt stacked cores (using 29M6 steel) with an air gap, to reduce D.C. core saturation.
- ) Primary impedance range from 2,500 to 10,000 Ohms.
- ) Secondary impedance range from 4 to 32 Ohms.

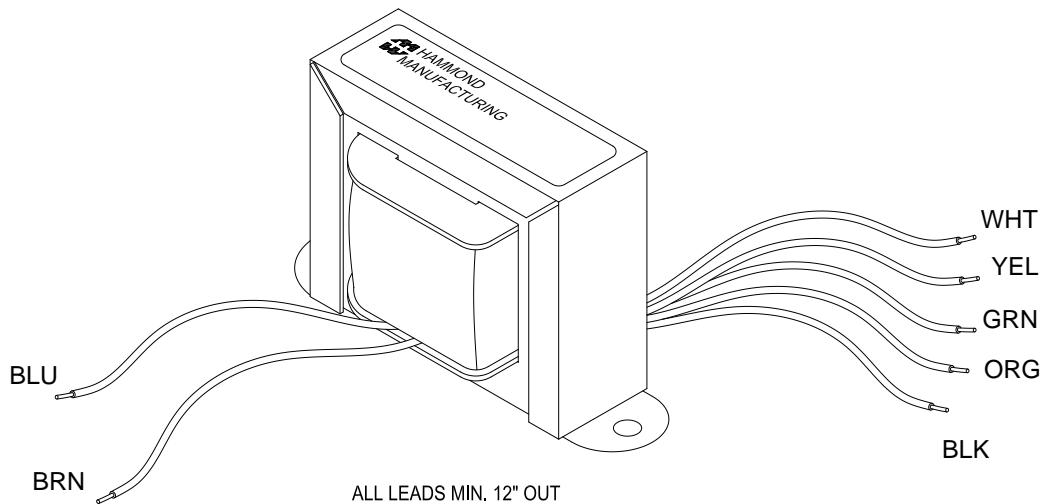

**ELECTRICAL SPECIFICATIONS\*\***

<u>Characteristic</u>	<u>Typical</u>
Input Impedance	2500 - 10000 $\varnothing$
Output Impedance	4/8/16/32 $\varnothing$
Output Power	8 Watts
Max. DC Bias	60 mA
<b>Primary - DCR</b>	
Blue - Brown	200 $\varnothing$
<b>Secondary DCR</b>	
Black - Orange	232 m $\varnothing$
Black - Green	312 m $\varnothing$
Black - Yellow	428 m $\varnothing$
Black - White	595 m $\varnothing$
<b>Inductance</b> @ 1.0 kHz, 1.0 V OC	
Primary - Blue - Brown	9.28 Hy
Sec - Black - Orange	5.00 mH
Sec - Black - Green	10.88 mH
Sec - Black - Yellow	20.40 mH
Sec - Black - White	43.25 mH
<b>Impedance</b> @ 1.0 kHz, 1.0 V OC	
Primary - Blue - Brown	57.50 K $\varnothing$
Sec - Black - Orange	32.44 $\varnothing$
Sec - Black - Green	66.33 $\varnothing$
Sec - Black - Yellow	132.0 $\varnothing$
Sec - Black - White	263.5 $\varnothing$
Frequency Response	See graphs for specific response, Typ. $\left\{ \begin{array}{l} 1.0\text{db from} \\ 100\text{Hz to } 15\text{KHz} \end{array} \right.$
Dielectric Strength	1500Vrms
Temperature Range	-40 To 105°C

**Schematic and Hook Up Data**

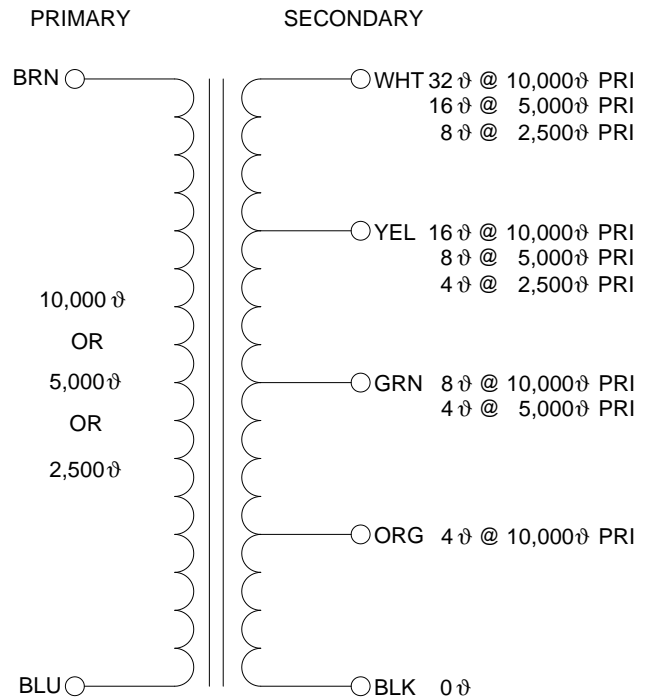

**HAMMOND MANUFACTURING** **125CSE**

**SINGLE ENDED AUDIO 8W 60mA DC**

PRI: 10,000; 5,000; 2,500 OHM

SEC: 4, 8, 16, 32 OHM

DATE CODE MADE IN CANADA

**125CSE Frequency Response Rs=10K $\Omega$**

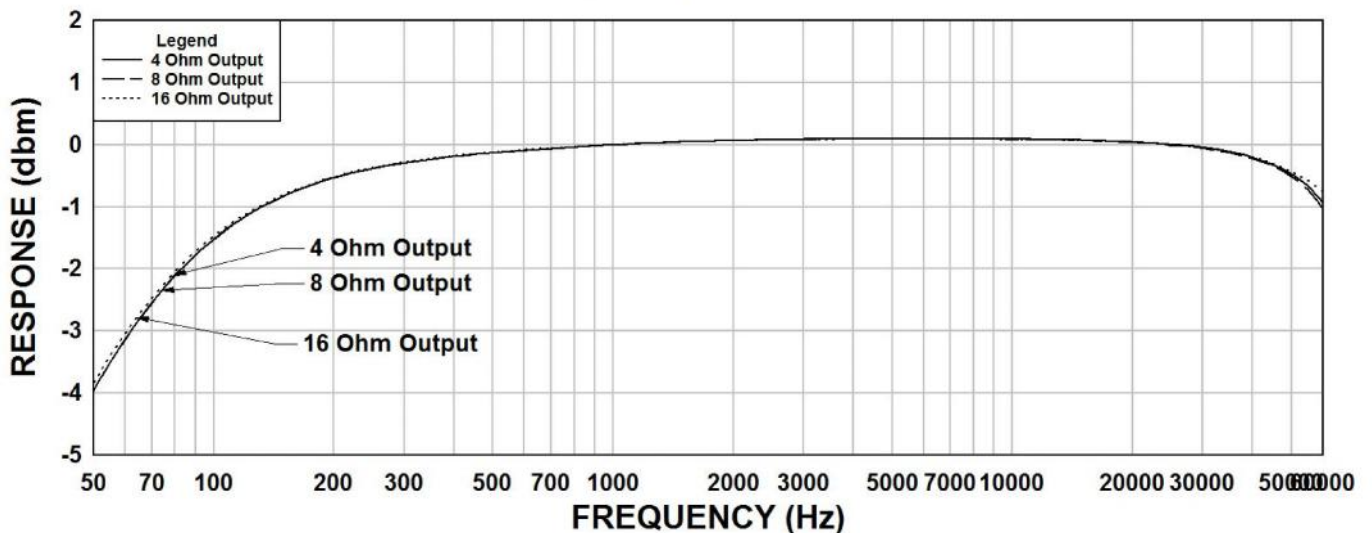

### 125 CSE Frequency Response $R_s=5K\Omega$

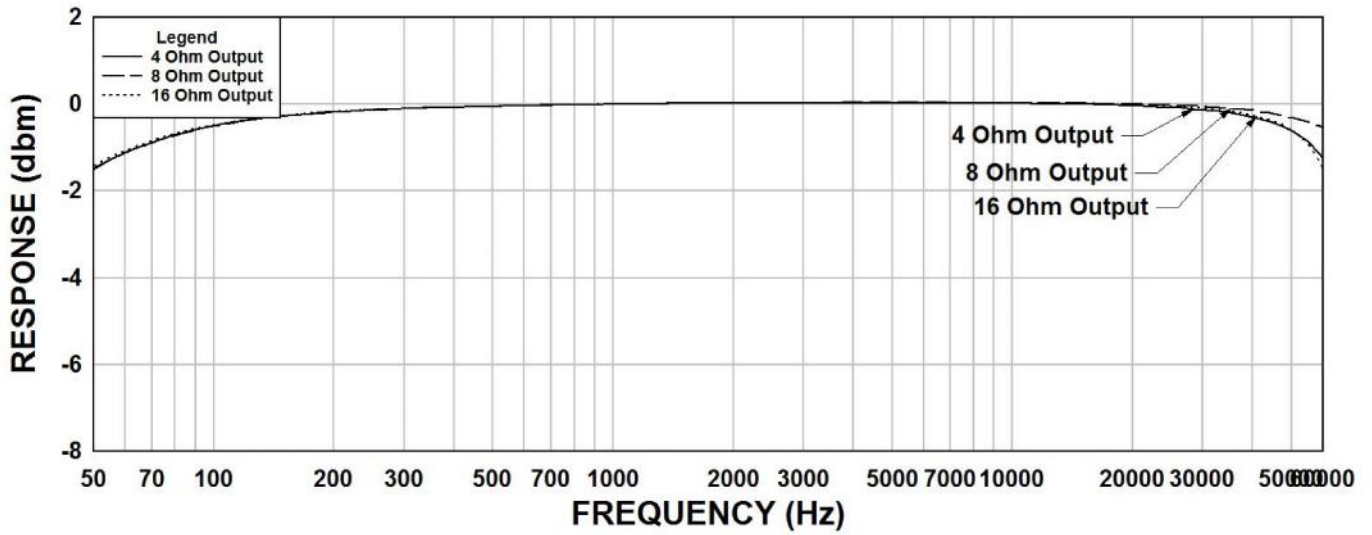

### 125CSE Frequency Response $R_s=2500\Omega$

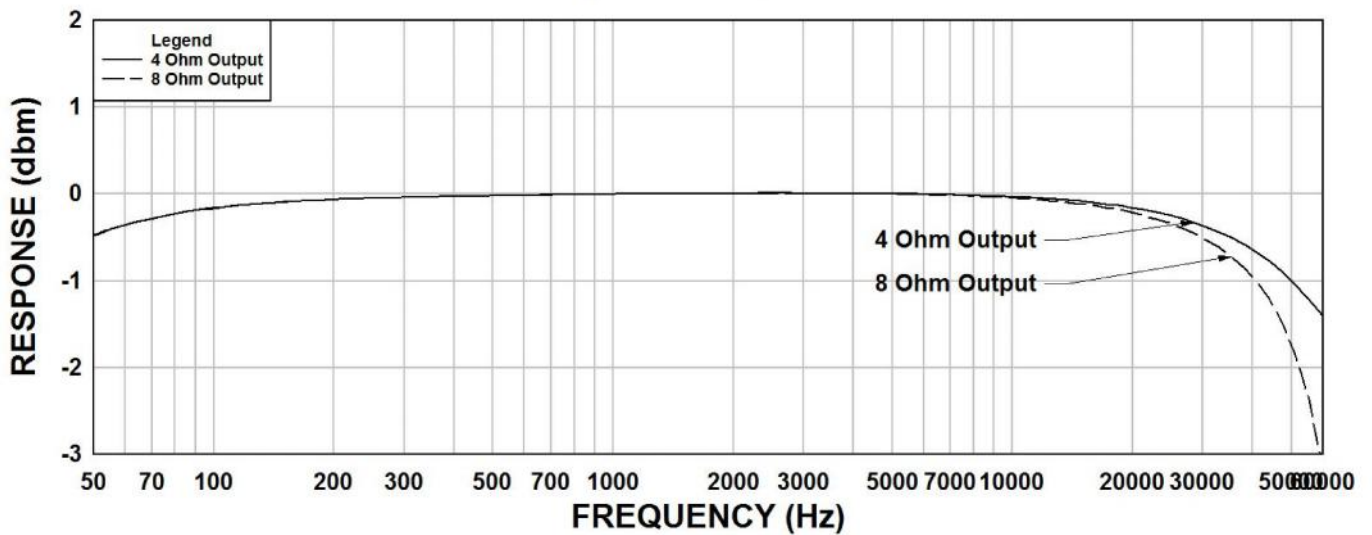

### 125CSE THD+N $R_s=10K\Omega$

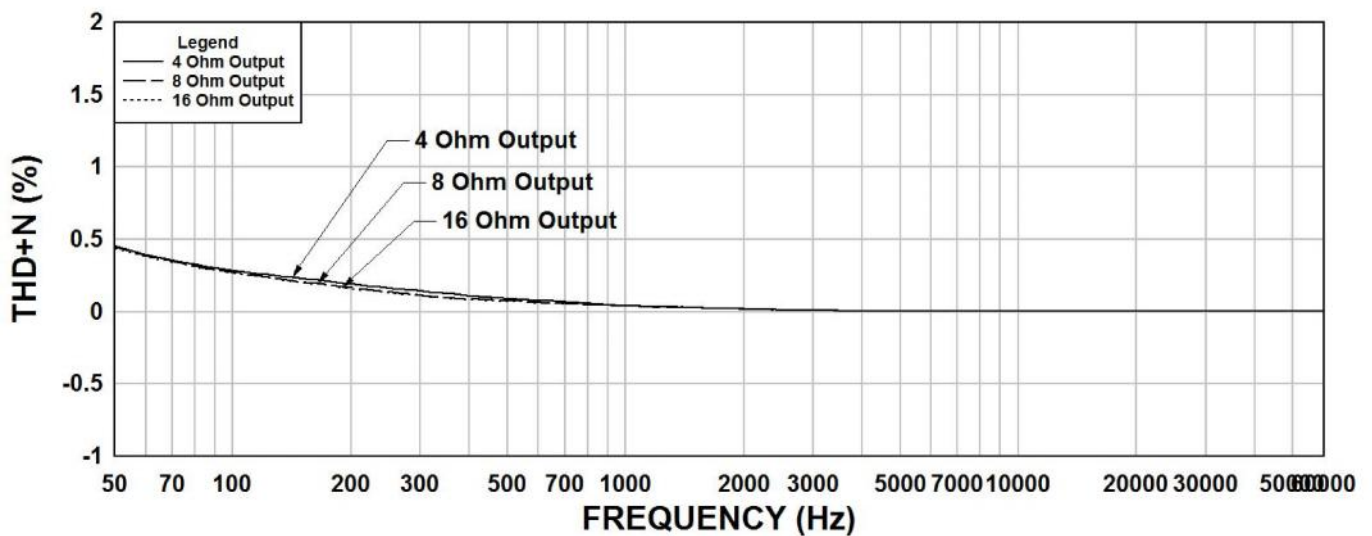

**125CSE THD+N Rs=5KΩ**

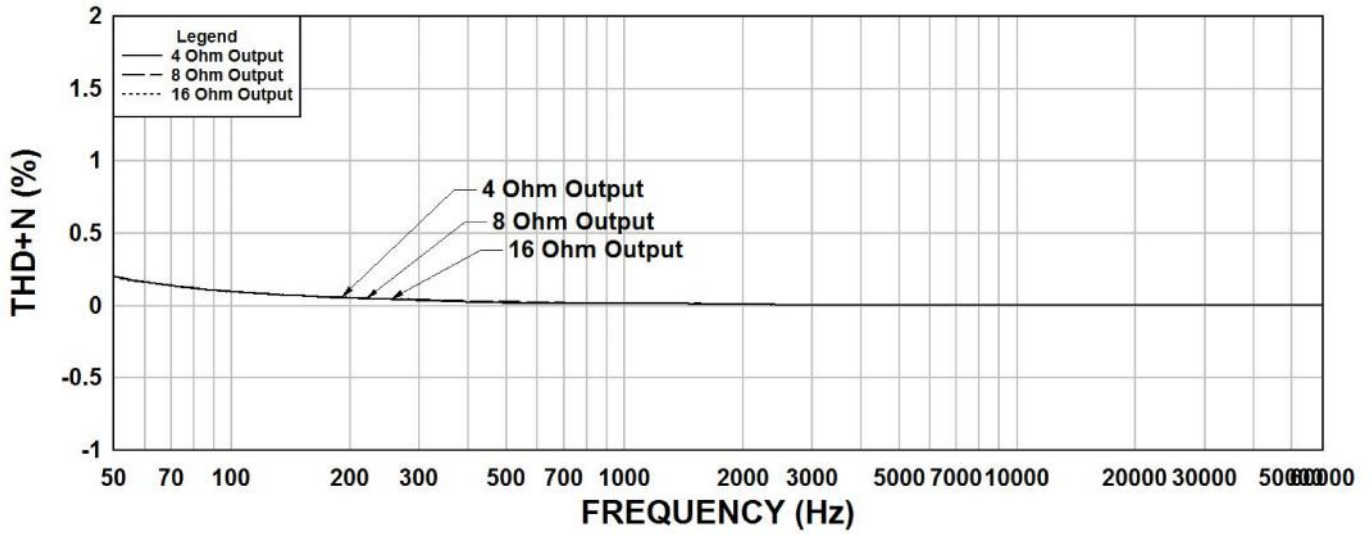

**125CSE THD+N Rs=2500Ω**

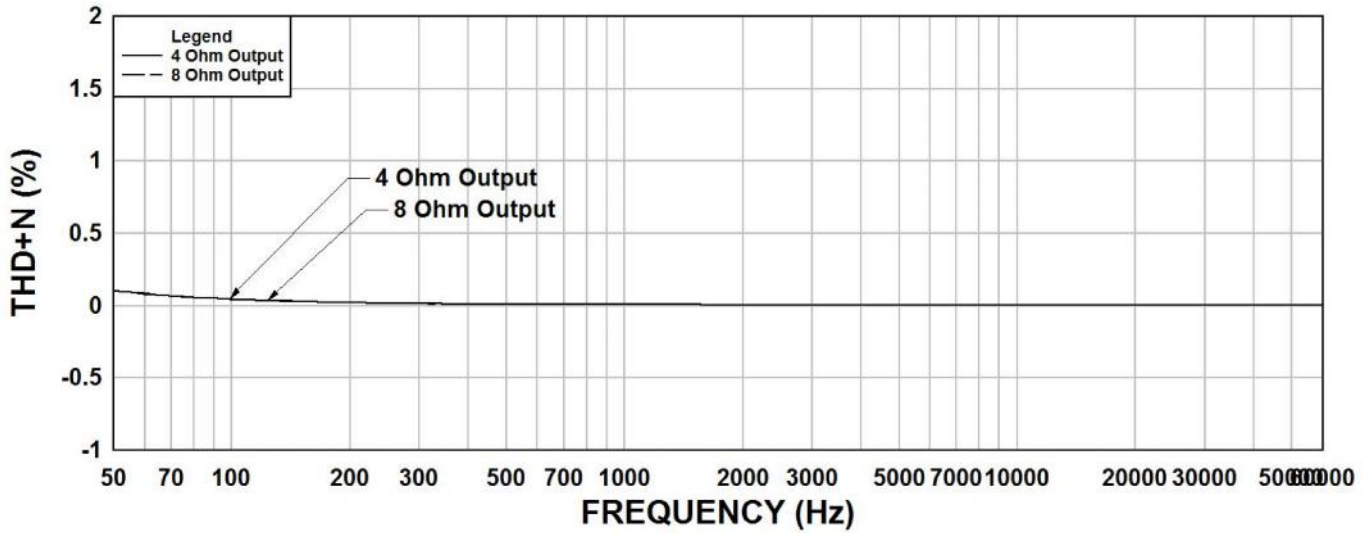

**125CSE Phase Shift Rs=10KΩ**

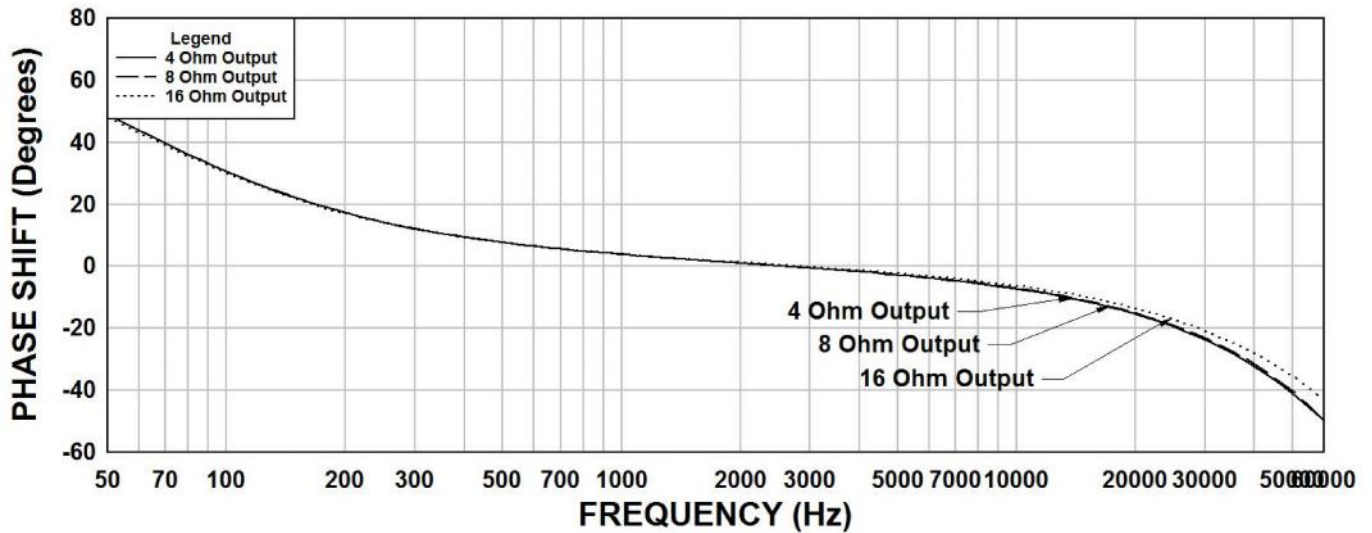

### 125CSE Phase Shift $R_s=5K\Omega$

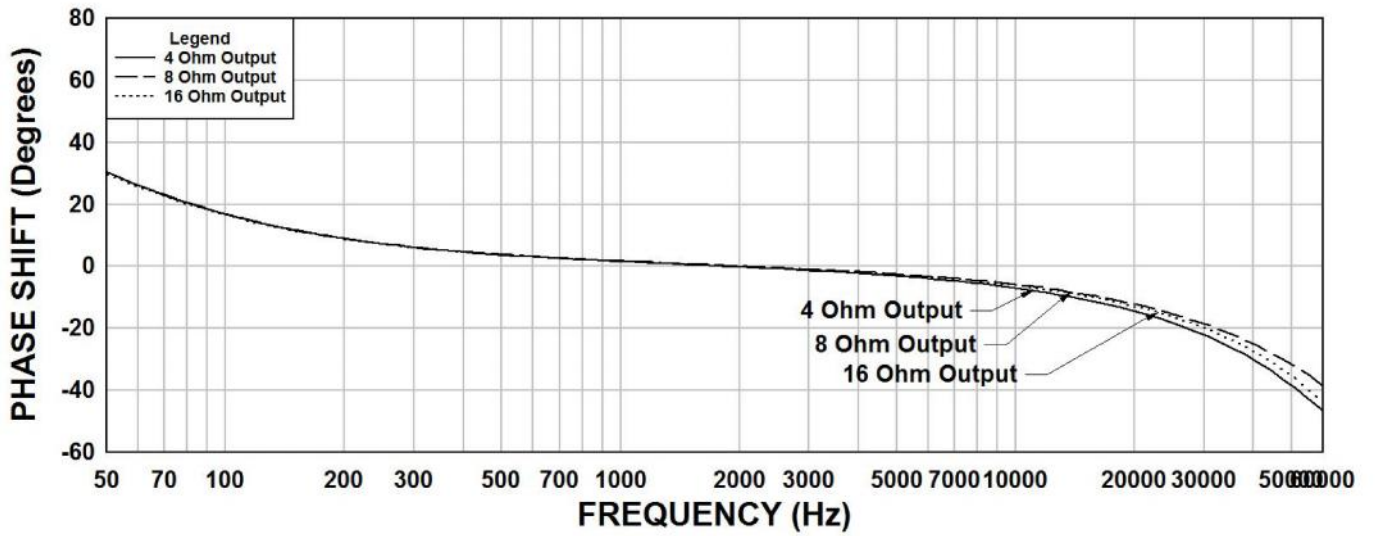

### Phase Shift 2500.xlsx

Phase Shift 2500 to 4 ohms

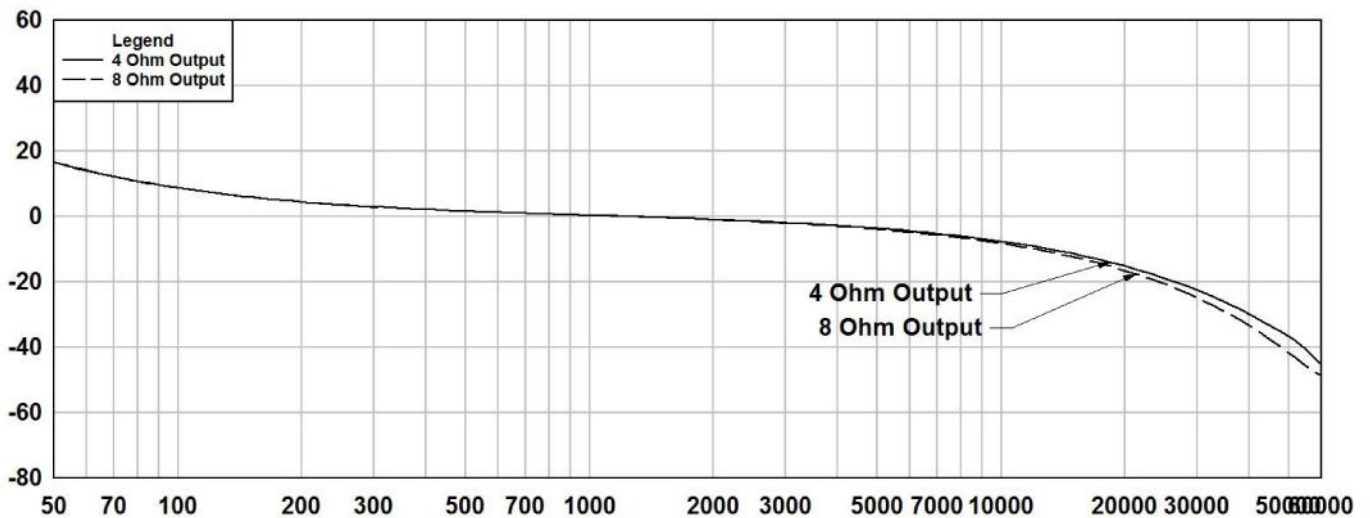

#### TYPICAL TEST CIRCUIT

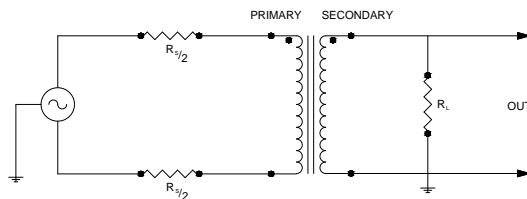

Measurement instruments  
 Hp4192a impedance analyzer  
 Hp3456a DVM  
 Keithley 2002 DVM  
 D scope series iii audio analyzer  
 Wayne Kerr 3255B with a 3265B

\* All graphs input level 20dbu.

\*\* The results are typical and are subject to normal manufacturing and electrical tolerances.

This drawing and the information in it is the property of Hammond Manufacturing. It may not be reproduced, transmitted or used in any manner whatsoever without the written permission of Hammond Manufacturing. Data subject to change without notice.