

EXTRUSION

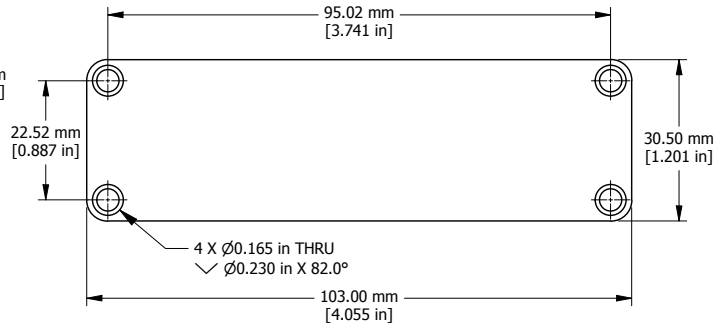

END PLATE

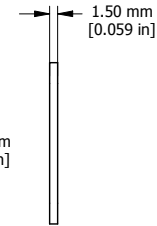

OPTIONAL FLANGE END PANELS
1455LF

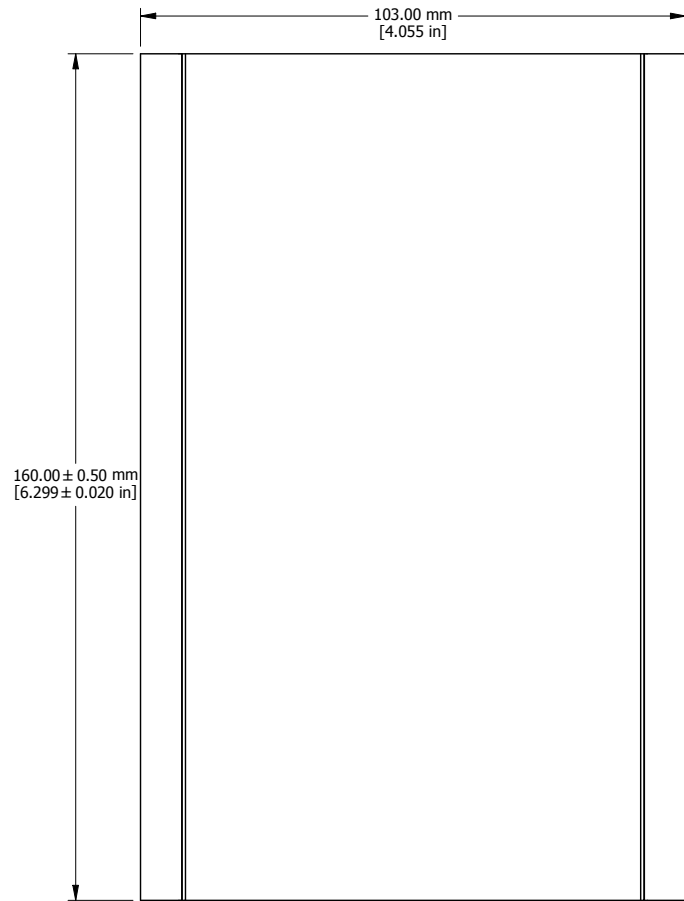

EXTRUSION DESIGNED FOR 100MM WIDE PC BOARD

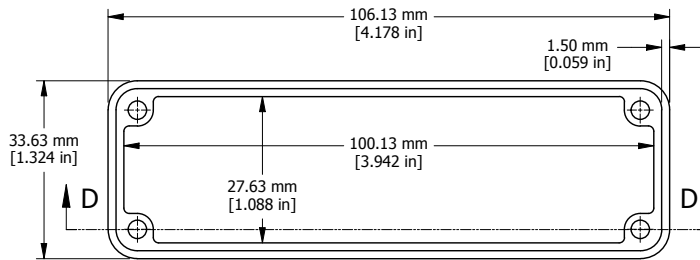

OPEN BEZEL

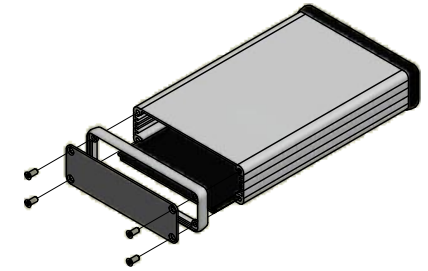
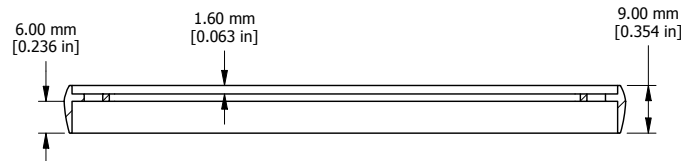

EXPLODED ASSEMBLY VIEW

Enclosures can be Factory Modified (Milling, Drilling, Printing etc.)
Solid models of this enclosure available in STEP or IGES.
Contact Factory mjm@hammondmfg.com

NOTE	
Purchased assembly includes box, plastic bezels, end panels, #6 Taptight screws and self adhesive rubber feet.	
Box made from Extruded Aluminum 6063.	
Bezels made with polycarbonate.	

1455L1601	
PART NUMBERS	
Clear Anodized	1455L1601
Black Anodized	1455L1601BK
Blue Anodized	1455K1601BU
Red Anodized	1455K1601RD
ACCESSORIES	
See website for accessories.	

