

ASSEMBLY - VIEW FROM FRONT

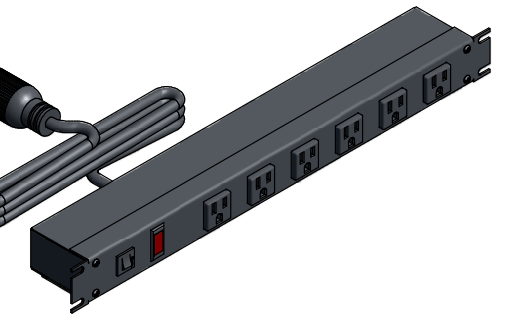

ISOMETRIC VIEW

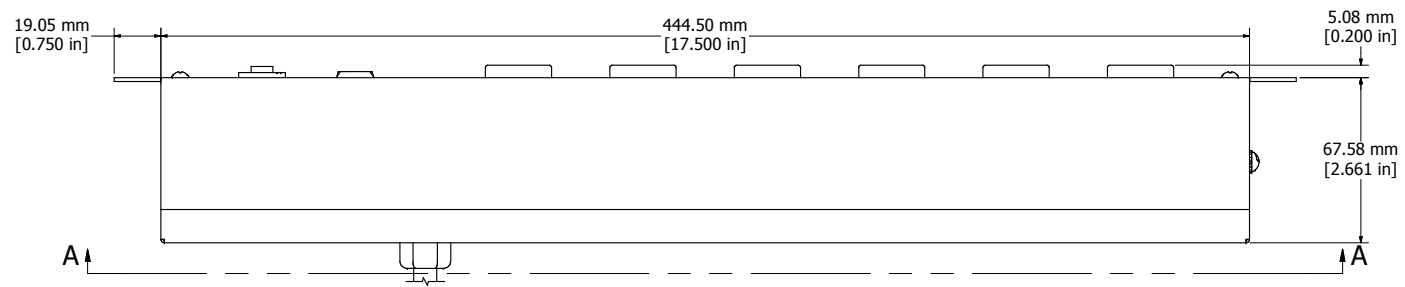
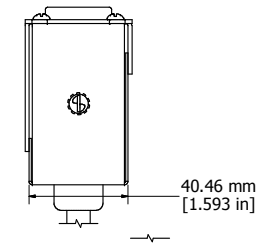

ASSEMBLY - VIEW FROM SIDE

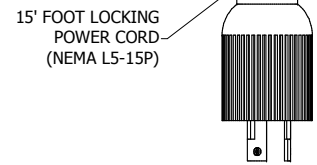

ASSEMBLY - VIEW FROM BOTTOM

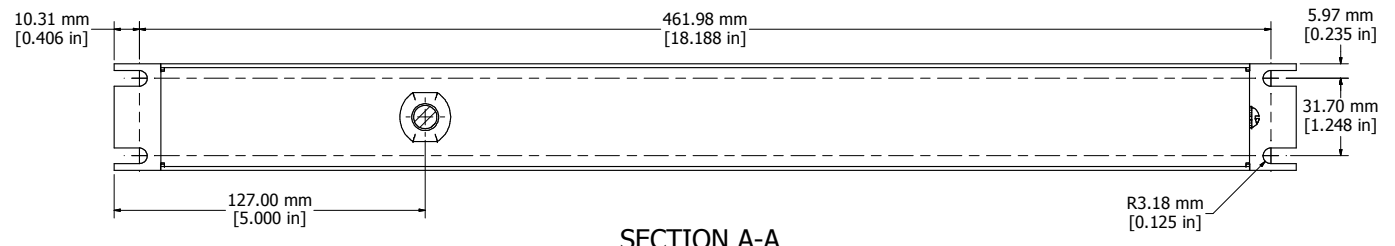

SECTION A-A

<b>1582T6D1BKRA</b>
Finish - Front - Black Painted Steel
Back - Black Painted Steel
Rated - 125 VAC, 60 Hz, 15 Amps
Approvals - CSA Certified Standards C22.2 (No. 21-95, 42-99)
- UL Recognized Standard UL1363

**HAMMOND MANUFACTURING™**

**1582T6D1BKRA**

[www.hammondmfg.com](http://www.hammondmfg.com)