

1751 Series Tube Guitar Amplifier Output Transformer

1751A

Features:

- Designed for drop in replacement of original units.
- Constructed to look similar to original factory units
- Nearly flat frequency response @ 40Hz. to 15 KHz (±1dB reference 1 KHz @ 27dBu drive)
- Ideal replacement for Gibson's Goldseal/Gold Tone GA15/GA15-RV part number (73-TRAN-15W-OP2)
- Weight: 1.32 lbs.

¹ *DISCLAIMER: Hammond Mfg. is not affiliated with Gibson Guitar Corporation. Amplifier model names are trademarks of the amplifier companies and are just listed here for reference purpose only.*

SCHEMATIC

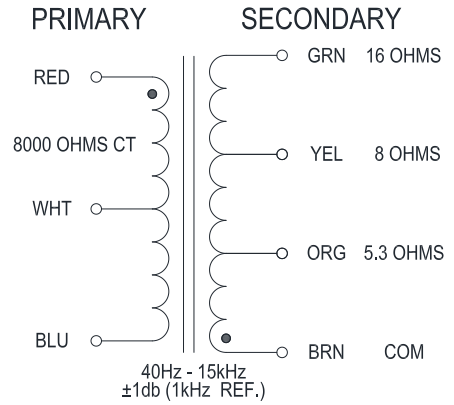

ELECTRICAL SPECIFICATIONS

Characteristics	Typical	
Input Impedance	8000 Ohms CT	
Output Impedance	5.3, 8 & 16 Ohms	
Output Power	15W	
DCR PRI Red-Blue	300.7Ω	±20%
DCR PRI Red-White	126.9Ω	±20%
DCR PRI White-Blue	173.9Ω	±20%
DCR SEC Brown-Orange	0.445Ω	±20%
DCR SEC Brown-Yellow	0.548Ω	±20%
DCR SEC Brown-Green	0.797Ω	±20%
Dielectric Strength	2500V RMS	
Temperature Class	Up to 105 degC	
Inductance Impedance	@ 1 KHz, 1 V OC	
PRI Red-Blue	37H	250 KOhms
PRI Red-White	10.3H	74 KOhms
Leakage Inductance	@ 1 KHz, 1 V SC	
PRI Red-Blue	31.70mH	
PRI Red-White	15.44mH	

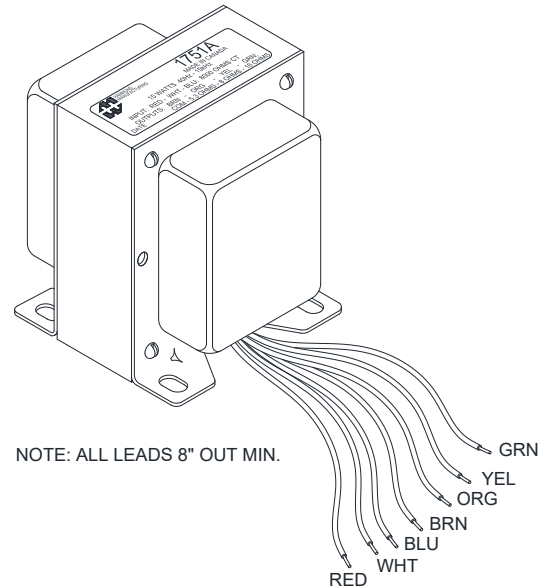

This drawing and the information in it is the property of Hammond Manufacturing. It may not be reproduced, transmitted or used in any manner whatsoever without the written permission of Hammond Manufacturing. Data subject to change without notice.

DIMENSIONAL DETAILS:

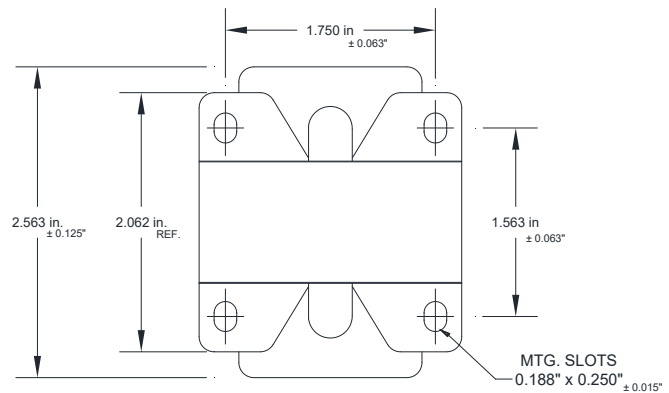
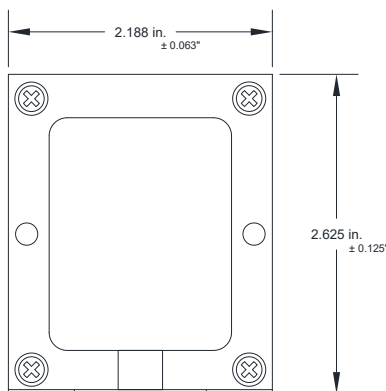

PERFORMANCE GRAPHS:

1751A Frequency Response @ 27dBu

RS = 8K Ohm @ 1KHz Reference

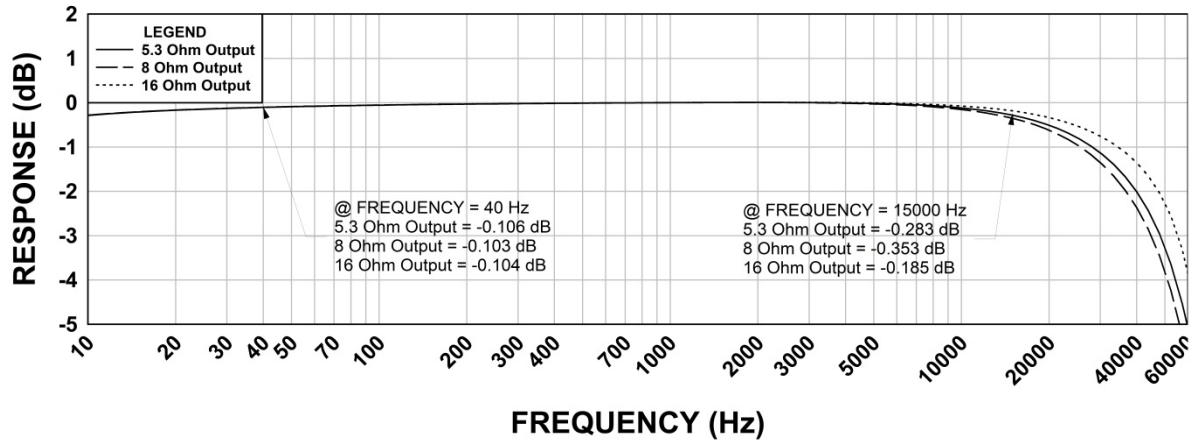

1751A THD+N

RS = 8K Ohms @ 1KHz Reference

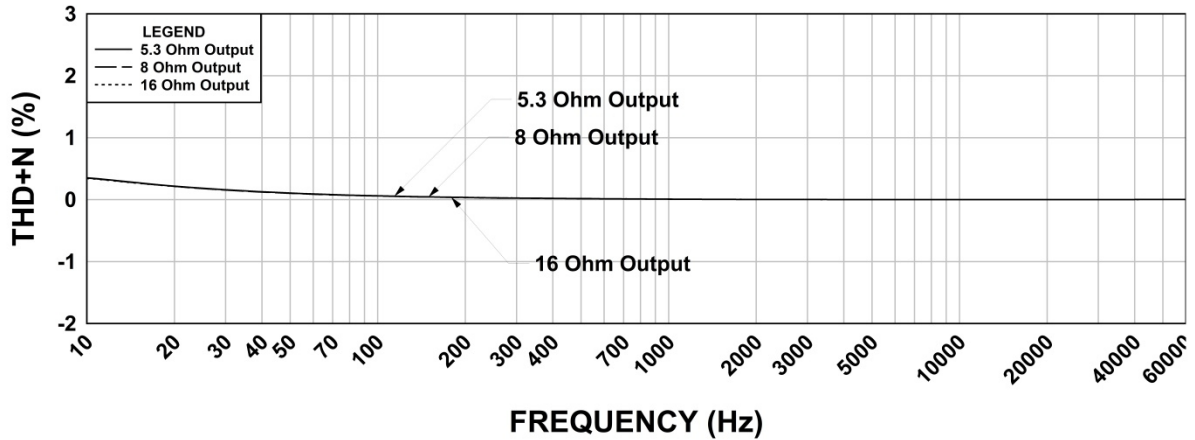

1751A Phase Shift @ 27dBu

RS = 8K Ohms @ 1KHz Reference

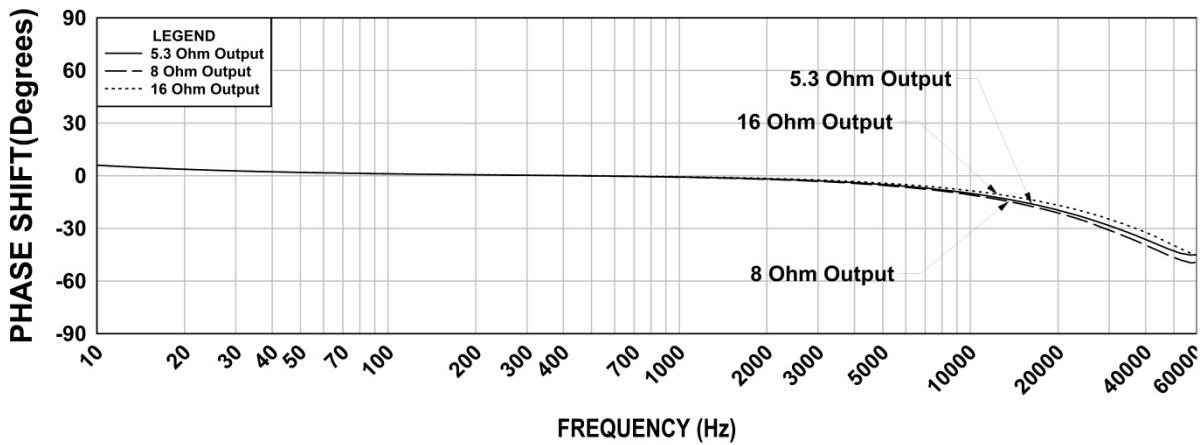

MEASUREMENT INSTRUMENTS

- dScope Series III Audio Analyzer
- Wayne Kerr 3255B with a 3265B Inductance Analyzer
- HP 4192a LF Impedance Analyzer
- Keithley 2010 DVM

**The results are typical and are subject to normal manufacturing and electrical tolerances.

TEST CONDITIONS

