

(4) EACH #10-32 BRASS INSERTS, AND STAINLESS STEEL FLANGE AND FEET SCREWS

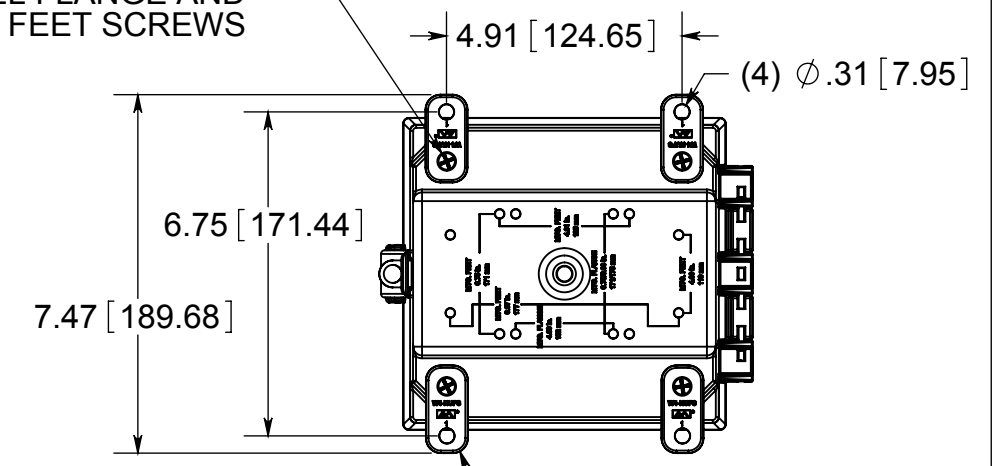

FRONT VIEW WITH COVER REMOVED AND BACK PANEL DISPLAYED

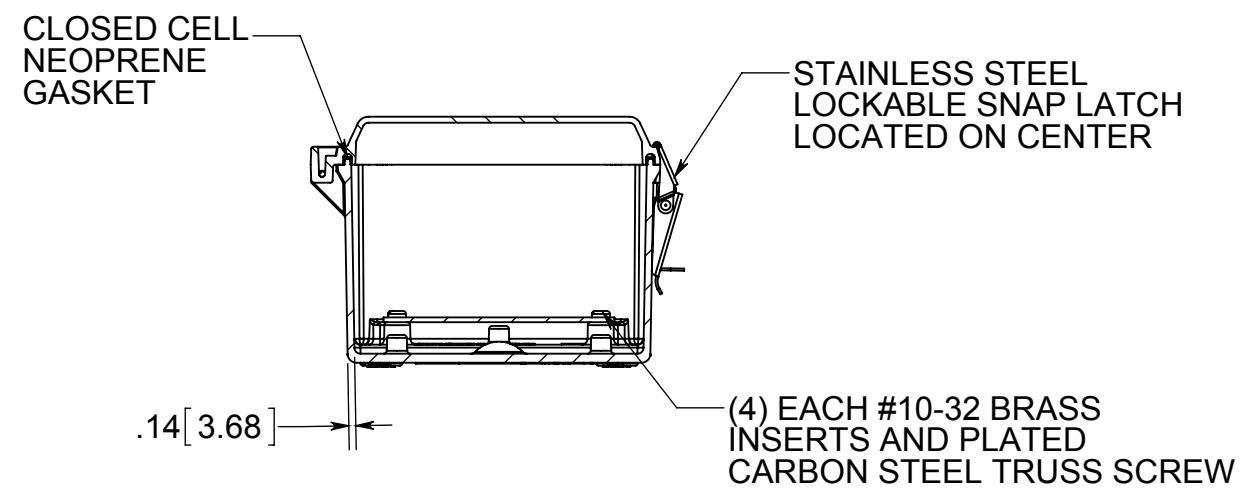
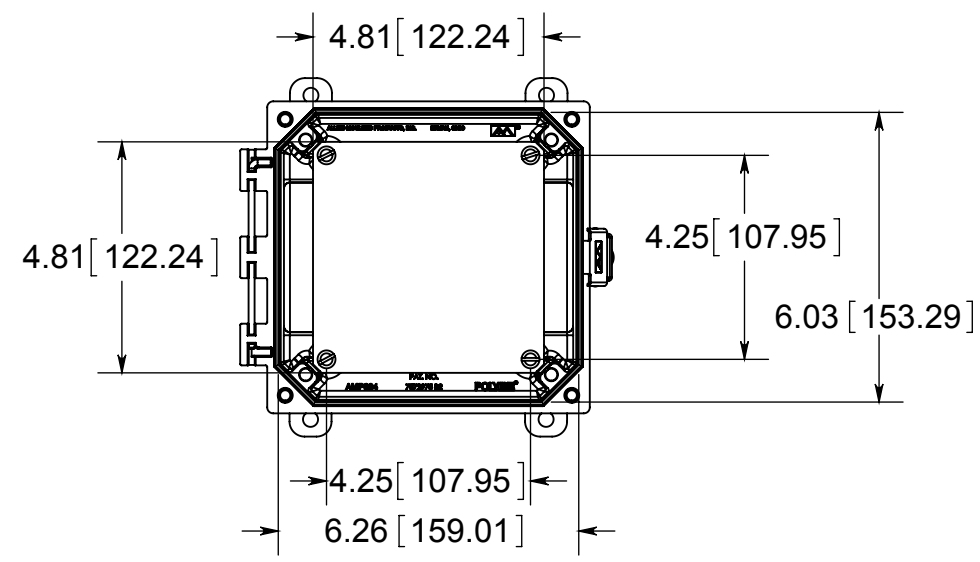

MATERIAL:
 BOX- INJECTED POLYCARBONATE
 STANDARD COVER- INJECTED POLYCARBONATE
 CLEAR COVER- INJECTED POLYCARBONATE

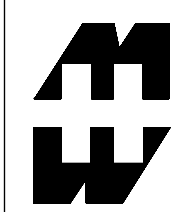

PART No. PCJ664L
 for more information visit www.hammfg.com
 Data subject to change without notice
 Drawing Not to Scale