

RASE - SERIES

ASSEMBLY INSTRUCTIONS FOR EQUIPMENT SHELF

BUL10374
REV. A
PAGE 1 OF 1

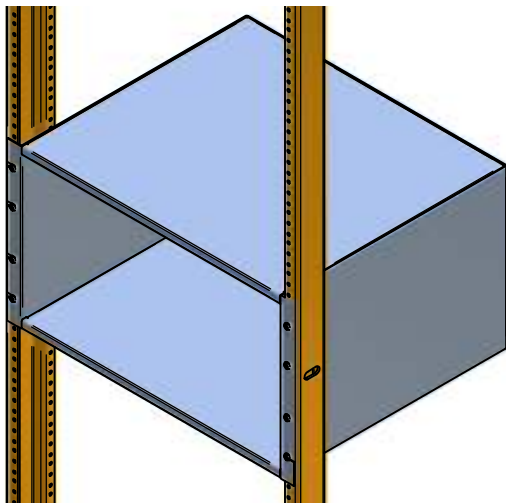
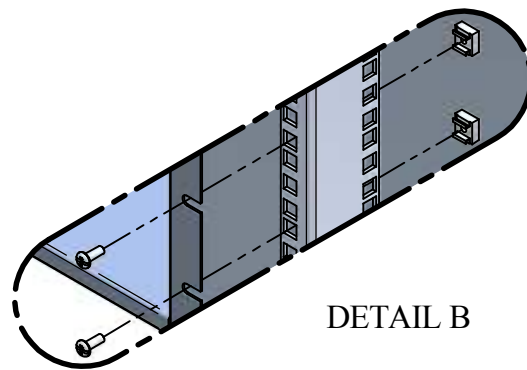
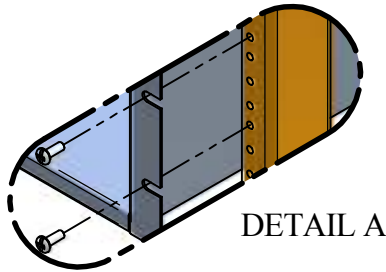
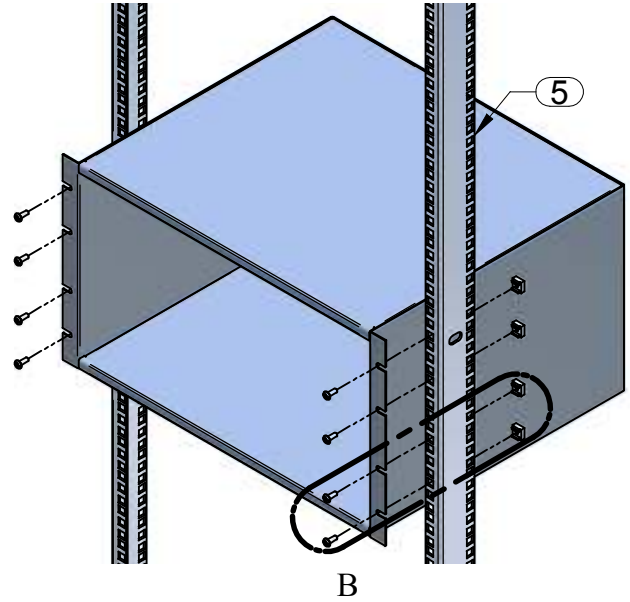
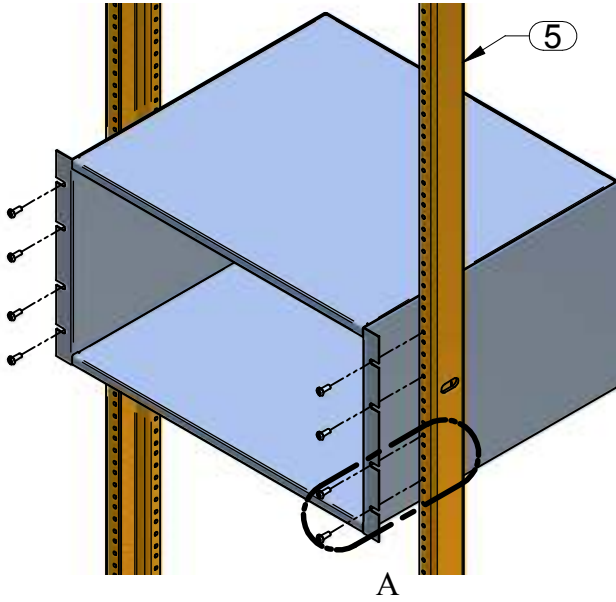

COMPLETE ASSEMBLY

ASSEMBLY INSTRUCTIONS

- A) Select the height at which to mount the equipment shelf (item 1) on the combination rails (item 4).
- B) If mounting rails have square cutouts insert 4 or 8 cage nuts (item 3) on the mounting rail to suit the spacing of the mounting slots. This can be done using a cage nut insertion tool. (Detail B)
- C) Line up the mounting slots of the shelf (item 1) with the holes (or cage nuts just inserted) on the combination rail (item 4). Secure with screws (items 2) purchased for the combination rails. (Detail A & B)

PARTS LIST

ITEM No.	DESCRIPTION	QTY
1	EQUIPMENT SHELF	1
2	SCREWS (NOT INCLUDED)	4 OR 8
3	CAGE NUTS (NOT INCLUDED)	4 OR 8
4	COMBINATION RAILS (NOT INCLUDED)	2

TOOL BOX



#2 Phillips Head
Screw Driver



visit our website @ www.hammondmfg.com